

1 N 200 BLOCK STATE ST - EAST SIDE - SIDEWALK PLAN - DEMOLITION
SCALE: 1/8" = 1'-0"

N 200 BLOCK STATE ST
TRAFFIC DIRECTION

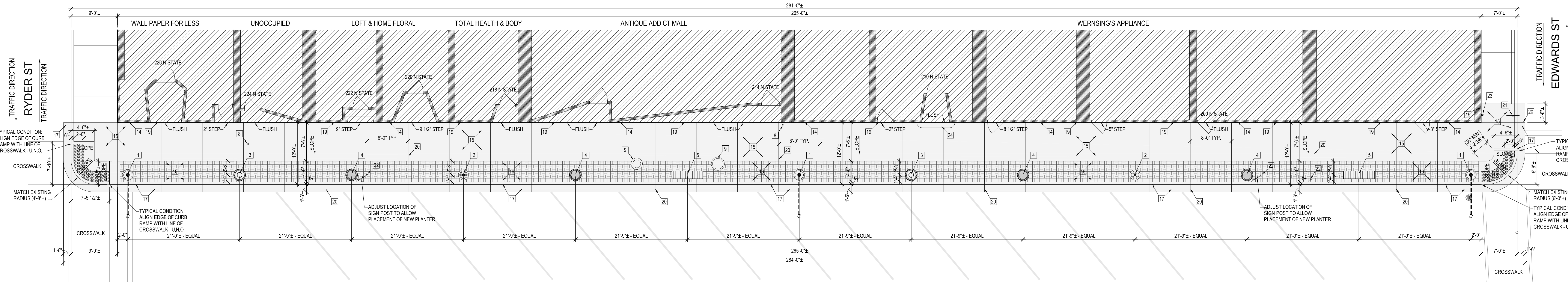

2 N 200 BLOCK STATE ST - EAST SIDE - SIDEWALK PLAN - NEW WORK
SCALE: 1/8" = 1'-0"

N 200 BLOCK STATE ST
TRAFFIC DIRECTION

KEYED NOTES - (NOT ALL KEYED NOTES USED EACH SHEET)

- | |
|---|
| <p>1 NEW ORNAMENTAL STREET LIGHT - SEE DTL. 5/A10
PROVIDE NEW CONC. FOUNDATION & U.G. ELEC. SERVICE</p> <p>2 NEW ORNAMENTAL LAMP POST - SEE DTL. 6/A10
PROVIDE NEW CONC. FOUNDATION & U.G. ELEC. SERVICE</p> <p>3 NEW TRASH RECEPTACLE - SEE DTL. 7/A10</p> <p>4 NEW PLANTER - SEE DTL. 9/A10</p> <p>5 NEW BENCH - SEE DTL. 9/A10</p> <p>6 EXISTING STREET LIGHT TO BE REMOVED - CAREFULLY REMOVE, SALVAGE & RE-INSTALL ALL EXISTING SIGNAGE ATTACHED TO POLE</p> <p>7 EXISTING BIKE RACK TO BE REMOVED</p> <p>8 EXISTING VALVE / COVER TO REMAIN - ADJUST ELEVATION AS REQ'D TO BE FLUSH WITH NEW SIDEWALK</p> <p>9 EXISTING MANHOLE COVER TO REMAIN - ADJUST ELEVATION AS REQ'D TO BE FLUSH WITH NEW SIDEWALK</p> <p>10 EXISTING DRAIN INLET TO REMAIN - ADJUST ELEVATION AS REQ'D TO BE FLUSH WITH NEW CURB / EXISTING PAVEMENT</p> <p>11 EXISTING TRASH RECEPTACLE TO BE REMOVED</p> <p>12 EXISTING CONCRETE SIDEWALK TO BE REMOVED</p> <p>13 EXISTING ASPHALT PAVEMENT TO BE REMOVED - SAW CUT AS REQ'D FOR INSTALLATION OF NEW CONCRETE CURB / GUTTER</p> <p>14 PROTECT ADJACENT EXISTING BUILDING</p> <p>15 NEW PLAIN CONCRETE SIDEWALK WITH BROOM FINISH</p> <p>16 NEW COLORED / STAMPED CONCRETE AMENITY STRIP</p> <p>17 NEW CONCRETE CURB / GUTTER - SEE DTL. 1/A10</p> <p>18 NEW DETECTABLE WARNING STRIP - SHALL BE 24" DEPTH x FULL WIDTH OF CURB RAMP. CAST-IN-PLACE POLYMER CONCRETE TILES, TRIM TO FIT RADIUS OF CURB. PROVIDE ALL ACCESSORIES AND INSTALL ACCORDING TO MANUFACTURER'S INSTRUCTIONS. ADA COMPLIANT TRUNCATED DOME TILES SHALL BE: BRICK RED AS MANUFACTURED BY ONE OF THE COMPANIES BELOW:
1. DETECTABLE WARNING SYSTEMS, INC. - www.detectable-warning.com
2. DETECTILE CORP. - www.detectile.com
OR ARCHITECT APPROVED EQUAL (SEE DTL. 10/A10)</p> <p>19 CONCRETE EXPANSION JOINT - PLACE AGAINST ALL ADJACENT STRUCTURES</p> <p>20 CONCRETE CONTROL JOINT - PLACE 8'-0" ON CENTER - SEE PLAN</p> <p>21 EXISTING STOP SIGN TO REMAIN</p> <p>22 EXISTING PARKING SIGN TO REMAIN</p> <p>23 EXISTING ROOF DRAIN TO UNDERGROUND TO REMAIN</p> <p>24 EXISTING CONCRETE TRANSITION RAMP TO BE REMOVED AND REPLACE WITH A NEW CONCRETE TRANSITION RAMP OF THE SAME CONFIGURATION AS THAT OF THE EXISTING, BUT INTEGRAL WITH NEW SURROUNDING CONCRETE SIDEWALK</p> <p>25 EXISTING CONCRETE MARKER TO REMAIN - PROTECT</p> <p>26 EXISTING FIRE HYDRANT TO REMAIN - PROTECT</p> <p>27 EXISTING PLYWOOD TRANSITION RAMP TO BE REMOVED, SALVAGED & RE-INSTALLED AFTER PLACEMENT OF NEW SIDEWALK</p> <p>28 EXISTING STONE STEP TO BE REMOVED, SALVAGED AND RE-INSTALLED AFTER PLACEMENT OF NEW SIDEWALK</p> <p>29 CONC. THRESHOLD RAMP</p> <p>30 NEW BENCH W/ BACK PROVIDED BY OWNER - INSTALLED BY CONTRACTOR - SEE DTL. 9/A10 (SIMILAR)</p> <p>31 EXISTING TRAFFIC SIGNAL POST TO REMAIN (PROTECT)</p> <p>32 EXISTING TRAFFIC SIGNAL CONTROL BOX TO REMAIN - ADJUST ELEVATION AS REQ'D TO BE FLUSH WITH NEW SIDEWALK</p> <p>33 REMOVE EXISTING LANDSCAPING, SHRUBS, BOULDERS, MULCH, ETC.</p> <p>34 EXISTING TREE - PROTECT</p> <p>35 REMOVE EXISTING BRICK PAVERS</p> <p>36 EXISTING FLAG POLE TO BE REMOVED, SALVAGED AND RE-INSTALLED ON A NEW CONCRETE BASE</p> <p>37 ASPHALT FILL</p> <p>38 REMOVE WOODEN PLANTER BOX</p> <p>39 EXISTING FIRE STANDPIPE TO REMAIN - PROTECT</p> <p>40 REMOVE EXISTING CROSS SIDEWALK DRAIN / COVER - INSTALL NEW CROSS SIDEWALK DRAIN / COVER - SEE DTL. 4/A10</p> <p>41 EXISTING VETERANS' MEMORIAL SIGN - PROTECT</p> <p>42 EXISTING STREETS SIGN TO REMAIN</p> <p>43 DASHED LINE & HATCHED AREA INDICATES BASEMENT SPACE & WALL BELOW SIDEWALK. DO NOT REMOVE CONCRETE ABOVE BASEMENT WALL & SPACE BELOW. FIELD VERIFY EXACT EXTENT OF BASEMENT & CAREFULLY DEMOLISH AROUND PERIMETER. PROVIDE AN APPROXIMATELY 1" THICK CONCRETE OVERLAY OVER REMAINING EXISTING CONCRETE SLAB TO MATCH NEW CONSTRUCTION. BLEND SLOPE OF CONCRETE SIDEWALK TO TRANSITION WITH NEW ADJACENT CONCRETE CONSTRUCTION.</p> |
|---|

GENERAL NOTES

ALL NEW SIDEWALK & CURB ELEVATIONS / SLOPES TO REMAIN AS EXISTING EXCEPT AT CORNER CURB RAMP AND/OR UNLESS NOTED OTHERWISE.

ALL SIDEWALK CROSS SLOPES SHALL SLOPE (1/8" / FT. MIN.) - (1/4" / FT. MAX.) TOWARD STREET & AWAY FROM BUILDINGS

REMOVE EXISTING OVERHEAD ELECTRICAL AND PROVIDE NEW UNDERGROUND ELECTRICAL CONDUIT - SEE ELECTRICAL DWGS. FOR MORE INFO.

ALL EXISTING VALVE / COVERS, MANHOLES, DRAIN INLETS, ETC. SHALL BE ADJUSTED TO BE FLUSH WITH NEW CURB / SIDEWALKS ELEVATIONS.

SCOPE OF WORK DEFINED BY SHADED AREA & HEAVY DASHED OUTLINE.

CONTRACTOR SHALL PROTECT ALL ADJACENT STRUCTURES, FIXTURES & PAVEMENTS AND BE FULLY RESPONSIBLE FOR DAMAGE BY CONTRACTOR.

CONTRACTOR SHALL BE REQUIRED TO SUPPLY ALL WARNING SIGNS AND BARRICADES NECESSARY FOR THE SAFETY OF THE GENERAL PUBLIC AND CONSTRUCTION PERSONNEL.

CONTRACTOR SHALL PROVIDE PEDESTRIAN ACCESS TO ALL BUILDINGS AT ALL TIMES DURING CONSTRUCTION. PEDESTRIAN BRIDGES, 4 FT. WIDE WITH RAILINGS 3 FT. HIGH SHALL BE PROVIDED BY THE CONTRACTOR TO PROVIDE ACCESS TO ALL BUILDINGS DURING SIDEWALK REPLACEMENT.

DELIVER PRODUCTS TO SITE IN MANUFACTURER'S ORIGINAL, UNOPENED CONTAINERS AND PACKAGING. UPON DELIVERY, EXAMINE PACKAGES IMMEDIATELY TO ENSURE ALL PRODUCTS ARE COMPLETE AND UNDAMAGED. STORE PRODUCTS IN A PROTECTED, DRY AREA. PROTECT PRODUCTS FROM DAMAGE DURING HANDLING AND INSTALLATION.

CONTRACTOR SHALL SCHEDULE THE SIDEWALK REMOVAL SO THAT IT WILL HAVE THE LEAST INTERFERENCE WITH THE BUSINESSES INVOLVED.

ALL SIDEWALK CONCRETE TO BE 4 IN. THICK WITH 6x6 - W1.4xW1.4 WWF, EXCEPT ANY SIDEWALK THAT INTERSECTS A DRIVEWAY SHALL BE POURED 6 IN. THICK THROUGH THE DRIVE AND AT LEAST 4 FT. EITHER SIDE OF THE DRIVE.

PROTECT ADJACENT EXISTING ASPHALT PAVEMENT FROM DAMAGE DURING CONSTRUCTION. REPAIR / REPLACE ANY DAMAGED AREA AS REQUIRED.

FINAL REVIEW DRAWINGS - NOT FOR CONSTRUCTION

ABBREVIATIONS

U.N.O.	UNLESS NOTED OTHERWISE
DTL.	DETAIL
CONC.	CONCRETE
U.G.	UNDERGROUND
ELEC.	ELECTRIC
RECD.	REQUIRED
TYP.	TYPICAL
G.C.	GENERAL CONTRACTOR
SIM.	SIMILAR
R	RADIUS

Illinois law requires anyone digging, regardless of the depth of the project, to call JULIE at 1-800-892-0123. This notice must be at least 48 hours/two working days prior to the start of excavation and the project must begin within 14 calendar days from the call.

NOTE: CONTRACTOR SHALL OBTAIN AND VERIFY ALL DIMENSIONS AND CONDITIONS AT JOB SITE AND BE FULLY RESPONSIBLE FOR SAME.

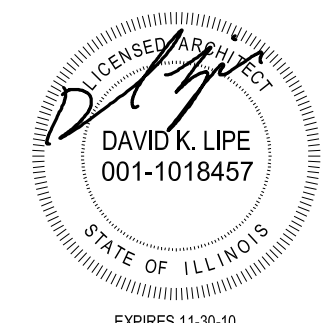

LIFE ARCHITECTURE
www.life-architecture.com
217-563-7636 phone
217-563-7643 fax

003 School Street
Nokomis, IL
62075

N 200 BLOCK STATE ST - EAST SIDE - SIDEWALK PLANS

City of Litchfield, Illinois - Downtown Streetscape - Phase 1

City of Litchfield, 120 E Ryder St, Litchfield, Illinois 62056

PROJ. NO.: 0809
DATE: 01-21-09
SHEET:
A2
SHEET 2 OF 11

TRAFFIC DIRECTION
N 200 BLOCK STATE ST
TRAFFIC DIRECTION

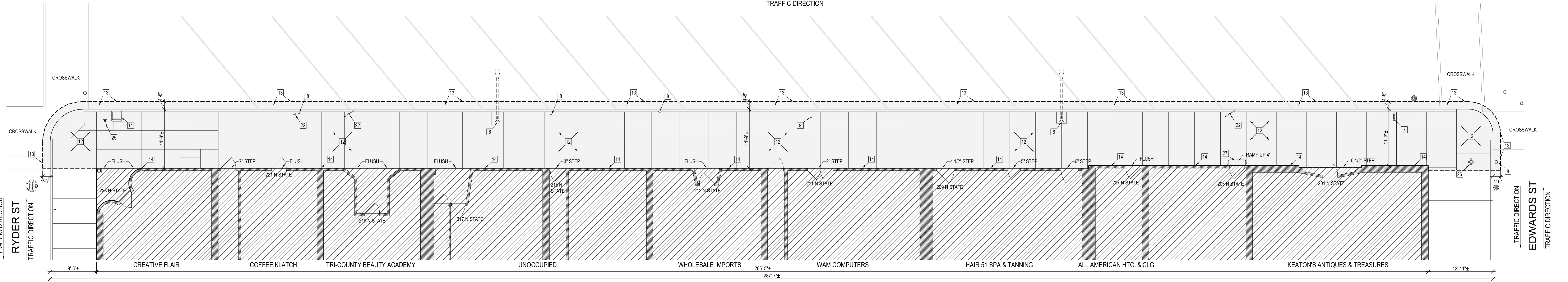

1 N 200 BLOCK STATE ST - WEST SIDE - SIDEWALK PLAN - DEMOLITION
SCALE: 1/8" = 1'-0"

TRAFFIC DIRECTION
N 200 BLOCK STATE ST
TRAFFIC DIRECTION

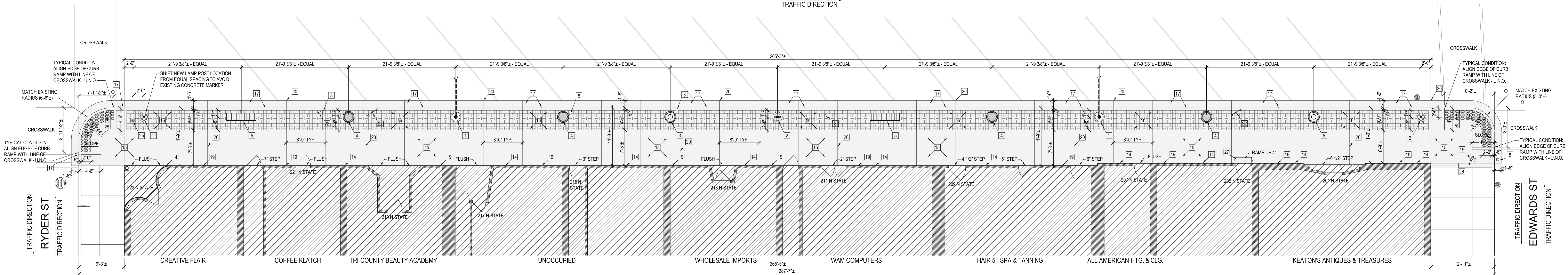

2 N 200 BLOCK STATE ST - WEST SIDE - SIDEWALK PLAN - NEW WORK
SCALE: 1/8" = 1'-0"

KEYED NOTES - (NOT ALL KEYED NOTES USED EACH SHEET)

- | | | |
|--|--|---|
| 1 NEW ORNAMENTAL STREET LIGHT - SEE DTL. 5/A10
PROVIDE NEW CONC. FOUNDATION & U.G. ELEC. SERVICE | 14 PROTECT ADJACENT EXISTING BUILDING | 26 EXISTING FIRE HYDRANT TO REMAIN - PROTECT |
| 2 NEW ORNAMENTAL LAMP POST - SEE DTL. 6/A10
PROVIDE NEW CONC. FOUNDATION & U.G. ELEC. SERVICE | 15 NEW PLAIN CONCRETE SIDEWALK WITH BROOM FINISH | 27 EXISTING PLYWOOD TRANSITION RAMP TO BE REMOVED,
SALVAGED & RE-INSTALLED AFTER PLACEMENT OF NEW SIDEWALK |
| 3 NEW TRASH RECEPTACLE - SEE DTL. 7/A10 | 16 NEW COLORED / STAMPED CONCRETE AMENITY STRIP | 28 EXISTING STONE STEP TO BE REMOVED, SALVAGED AND
RE-INSTALLED AFTER PLACEMENT OF NEW SIDEWALK |
| 4 NEW PLANTER - SEE DTL. 9/A10 | 17 NEW CONCRETE CURB / GUTTER - SEE DTL. 1/A10 | 29 CONC. THRESHOLD RAMP |
| 5 NEW BENCH - SEE DTL. 9/A10 | 18 NEW DETECTABLE WARNING STRIP - SHALL BE 2" DEPTH x FULL WIDTH
OF CURB RAMP. CAST-IN-PLACE POLYMER CONCRETE TILES, TRIM TO
FIT RADIUS OF CURB. PROVIDE ALL ACCESSORIES AND INSTALL ACCORDING
TO MANUFACTURER'S INSTRUCTIONS. ADA COMPLIANT TRUNCATED DOME TILES
SHALL BE BRICK RED AS MANUFACTURED BY ONE OF THE COMPANIES BELOW:
1. DETECTABLE WARNING SYSTEMS, INC. - www.detectable-warning.com
2. DETECTILE CORP. - www.detectile.com
OR ARCHITECT APPROVED EQUAL (SEE DTL. 10/A10) | 30 NEW BENCH W/ BACK PROVIDED BY OWNER
INSTALLED BY CONTRACTOR - SEE DTL. 9/A10 (SIMILAR) |
| 6 EXISTING STREET LIGHT TO BE REMOVED -
CAREFULLY REMOVE, SALVAGE & RE-INSTALL
ALL EXISTING SIGNAGE ATTACHED TO POLE | 19 CONCRETE EXPANSION JOINT - PLACE AGAINST ALL ADJACENT STRUCTURES | 31 EXISTING TRAFFIC SIGNAL POST TO REMAIN (PROTECT) |
| 7 EXISTING BIKE RACK TO BE REMOVED | 20 CONCRETE CONTROL JOINT - PLACE 8'-0" ON CENTER - SEE PLAN | 32 EXISTING TRAFFIC SIGNAL CONTROL BOX TO REMAIN - ADJUST
ELEVATION AS REQ'D TO BE FLUSH WITH NEW SIDEWALK |
| 8 EXISTING VALVE / COVER TO REMAIN - ADJUST
ELEVATION AS REQ'D TO BE FLUSH WITH NEW SIDEWALK | 21 EXISTING STOP SIGN TO REMAIN | 33 REMOVE EXISTING LANDSCAPING, SHRUBS, BOULDERS, MULCH, ETC. |
| 9 EXISTING MANHOLE COVER TO REMAIN - ADJUST
ELEVATION AS REQ'D TO BE FLUSH WITH NEW SIDEWALK | 22 EXISTING PARKING SIGN TO REMAIN | 34 EXISTING TREE - PROTECT |
| 10 EXISTING DRAIN INLET TO REMAIN - ADJUST ELEVATION
AS REQ'D TO BE FLUSH WITH NEW CURB / EXISTING PAVEMENT | 23 EXISTING ROOF DRAIN TO UNDERGROUND TO REMAIN | 35 REMOVE EXISTING BRICK PAVERS |
| 11 EXISTING TRASH RECEPTACLE TO BE REMOVED | 24 EXISTING CONCRETE TRANSITION RAMP TO BE REMOVED AND
REPLACE WITH A NEW CONCRETE TRANSITION RAMP OF THE SAME
CONFIGURATION AS THAT OF THE EXISTING, BUT INTEGRAL WITH
NEW SURROUNDING CONCRETE SIDEWALK | 36 EXISTING FLAG POLE TO BE REMOVED, SALVAGED AND
RE-INSTALLED ON A NEW CONCRETE BASE |
| 12 EXISTING CONCRETE SIDEWALK TO BE REMOVED | 25 EXISTING CONCRETE MARKER TO REMAIN - PROTECT | 37 ASPHALT FILL |
| 13 EXISTING ASPHALT PAVEMENT TO BE REMOVED - SAW CUT AS
REQ'D FOR INSTALLATION OF NEW CONCRETE CURB / GUTTER | | 38 REMOVE WOODEN PLANTER BOX |
| | | 39 EXISTING FIRE STANDPIPE TO REMAIN - PROTECT |
| | | 40 REMOVE EXISTING CROSS SIDEWALK DRAIN / COVER -
INSTALL NEW CROSS SIDEWALK DRAIN / COVER - SEE DTL. 4/A10 |
| | | 41 EXISTING VETERANS' MEMORIAL SIGN - PROTECT |
| | | 42 EXISTING STREETS SIGN TO REMAIN |
| | | 43 DASHED LINE & HATCHED AREA INDICATES
BASEMENT SPACE & WALL BELOW SIDEWALK.
DO NOT REMOVE CONCRETE ABOVE BASEMENT
WALL & SPACE BELOW. FIELD VERIFY EXACT EXTENT
OF BASEMENT & CAREFULLY DEMOLISH AROUND
PERIMETER. PROVIDE AN APPROXIMATELY 1" THICK
CONCRETE OVERLAY OVER REMAINING EXISTING
CONCRETE SLAB TO MATCH NEW CONSTRUCTION.
BLEND SLOPE OF CONCRETE SIDEWALK TO TRANSITION
WITH NEW ADJACENT CONCRETE CONSTRUCTION. |

GENERAL NOTES

ALL NEW SIDEWALK & CURB ELEVATIONS / SLOPES TO REMAIN AS EXISTING EXCEPT AT CORNER CURB RAMPS AND/OR UNLESS NOTED OTHERWISE.

ALL SIDEWALK CROSS SLOPES SHALL SLOPE (1/8" / FT. MIN.) - (1/4" / FT. MAX.) TOWARD STREET & AWAY FROM BUILDINGS

REMOVE EXISTING OVERHEAD ELECTRICAL AND PROVIDE NEW UNDERGROUND ELECTRICAL CONDUIT - SEE ELECTRICAL DWGS. FOR MORE INFO.

ALL EXISTING VALVE / COVERS, MANHOLES, DRAIN INLETS, ETC. SHALL BE ADJUSTED TO BE FLUSH WITH NEW CURB / SIDEWALKS ELEVATIONS.

SCOPE OF WORK DEFINED BY SHADED AREA & HEAVY DASHED OUTLINE.

CONTRACTOR SHALL PROTECT ALL ADJACENT STRUCTURES, FIXTURES & PAVEMENTS AND BE FULLY RESPONSIBLE FOR DAMAGE BY CONTRACTOR.

CONTRACTOR SHALL BE REQUIRED TO SUPPLY ALL WARNING SIGNS AND BARRICADES NECESSARY FOR THE SAFETY OF THE GENERAL PUBLIC AND CONSTRUCTION PERSONNEL.

CONTRACTOR SHALL PROVIDE PEDESTRIAN ACCESS TO ALL BUILDINGS AT ALL TIMES DURING CONSTRUCTION. PEDESTRIAN BRIDGES, 4 FT. WIDE WITH RAILINGS 3 FT. HIGH SHALL BE PROVIDED BY THE CONTRACTOR TO PROVIDE ACCESS TO ALL BUILDINGS DURING SIDEWALK REPLACEMENT.

DELIVER PRODUCTS TO SITE IN MANUFACTURER'S ORIGINAL, UNOPENED CONTAINERS AND PACKAGING. UPON DELIVERY, EXAMINE PACKAGES IMMEDIATELY TO ENSURE ALL PRODUCTS ARE COMPLETE AND UNDAMAGED. STORE PRODUCTS IN A PROTECTED, DRY AREA. PROTECT PRODUCTS FROM DAMAGE DURING HANDLING AND INSTALLATION.

CONTRACTOR SHALL SCHEDULE THE SIDEWALK REMOVAL SO THAT IT WILL HAVE THE LEAST INTERFERENCE WITH THE BUSINESSES INVOLVED.

ALL SIDEWALK CONCRETE TO BE 4 IN. THICK WITH 6x6 - W1.4W1.4 WWF, EXCEPT ANY SIDEWALK THAT INTERSECTS A DRIVEWAY SHALL BE POURED 6 IN. THICK THROUGH THE DRIVE AND AT LEAST 4 FT. EITHER SIDE OF THE DRIVE.

PROTECT ADJACENT EXISTING ASPHALT PAVEMENT FROM DAMAGE DURING CONSTRUCTION. REPAIR / REPLACE ANY DAMAGED AREA AS REQUIRED.

ALL WORK TO COMPLY WITH:
ADA ACCESSIBILITY GUIDELINES
ILLINOIS ACCESSIBILITY CODE
INTERNATIONAL BUILDING CODE - 2006
NATIONAL ELECTRIC CODE - LATEST EDITION
CITY OF LITCHFIELD - CODE OF ORDINANCES

ABBREVIATIONS

U.N.O.	UNLESS NOTED OTHERWISE
DTL.	DETAIL
CONC.	CONCRETE
U.G.	UNDERGROUND
ELEC.	ELECTRIC
RECD.	REQUIRED
TYP.	TYPICAL
G.C.	GENERAL CONTRACTOR
SIM.	SIMILAR
R	RADIUS

FINAL REVIEW DRAWINGS - NOT FOR CONSTRUCTION

Illinois law requires anyone digging, regardless of the depth of the project, to call JULIE at 1-800-892-0123. This notice must be at least 48 hours/two working days prior to the start of excavation and the project must begin within 14 calendar days from the call.

NOTE: CONTRACTOR SHALL OBTAIN AND VERIFY ALL DIMENSIONS AND CONDITIONS AT JOB SITE AND BE FULLY RESPONSIBLE FOR SAME.

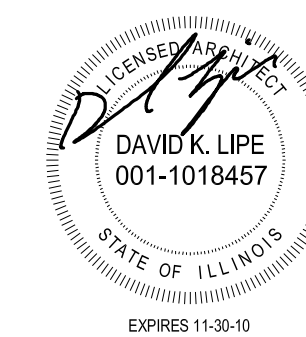

N 200 BLOCK STATE ST - WEST SIDE - SIDEWALK PLANS
City of Litchfield, Illinois - Downtown Streetscape - Phase 1
City of Litchfield, 120 E Ryder St, Litchfield, Illinois 62056

PROJ. NO.: 0809
DATE: 01-21-09
SHEET:
A3
SHEET 3 OF 11

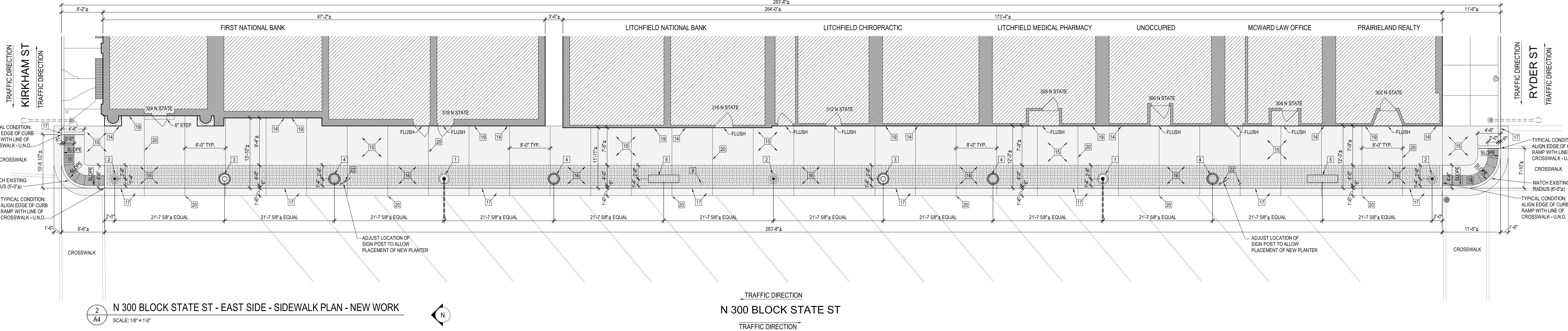
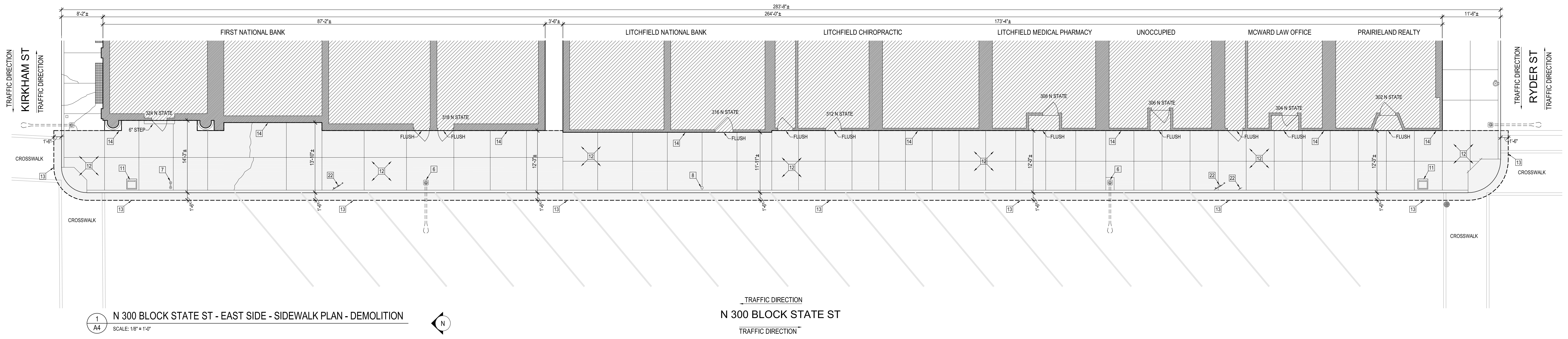

KEYED NOTES - (NOT ALL KEYED NOTES USED EACH SHEET)

- | | | | |
|---|--|--|--|
| <p>1 NEW ORNAMENTAL STREET LIGHT - SEE DTL. 5A/10
PROVIDE NEW CONC. FOUNDATION & U.G. ELEC. SERVICE</p> <p>2 NEW ORNAMENTAL LAMP POST - SEE DTL. 6A/10
PROVIDE NEW CONC. FOUNDATION & U.G. ELEC. SERVICE</p> <p>3 NEW TRASH RECEPTACLE - SEE DTL. 7A/10</p> <p>4 NEW PLANTER - SEE DTL. 9A/10</p> <p>5 NEW BENCH - SEE DTL. 9A/10</p> <p>6 EXISTING STREET LIGHT TO BE REMOVED - CAREFULLY REMOVE, SALVAGE & RE-INSTALL ALL EXISTING SIGNAGE ATTACHED TO POLE</p> <p>7 EXISTING BIKE RACK TO BE REMOVED</p> <p>8 EXISTING VALVE / COVER TO REMAIN - ADJUST ELEVATION AS REQ'D TO BE FLUSH WITH NEW SIDEWALK</p> <p>9 EXISTING MANHOLE COVER TO REMAIN - ADJUST ELEVATION AS REQ'D TO BE FLUSH WITH NEW SIDEWALK</p> <p>10 EXISTING DRAIN INLET TO REMAIN - ADJUST ELEVATION AS REQ'D TO BE FLUSH WITH NEW CURB / EXISTING PAVEMENT</p> <p>11 EXISTING TRASH RECEPTACLE TO BE REMOVED</p> <p>12 EXISTING CONCRETE SIDEWALK TO BE REMOVED</p> <p>13 EXISTING ASPHALT PAVEMENT TO BE REMOVED - SAW CUT AS REQ'D FOR INSTALLATION OF NEW CONCRETE CURB / GUTTER</p> | <p>14 PROTECT ADJACENT EXISTING BUILDING</p> <p>15 NEW PLAIN CONCRETE SIDEWALK WITH BROOM FINISH</p> <p>16 NEW COLORED / STAMPED CONCRETE AMENITY STRIP</p> <p>17 NEW CONCRETE CURB / GUTTER - SEE DTL. 1A/10</p> <p>18 NEW DETECTABLE WARNING STRIP - SHALL BE 2" DEPTH x FULL WIDTH OF CURB RAMP. CAST-IN-PLACE POLYMER CONCRETE TILES, TRIM TO FIT RADIUS OF CURB. PROVIDE ALL ACCESSORIES AND INSTALL ACCORDING TO MANUFACTURER'S INSTRUCTIONS. ADA COMPLIANT TRUNCATED DOME TILES SHALL BE: BRICK RED AS MANUFACTURED BY ONE OF THE COMPANIES BELOW:
1. DETECTABLE WARNING SYSTEMS, INC. - www.detectable-warning.com
2. DETECTIBLE CORP. - www.detectible.com
OR ARCHITECT APPROVED EQUAL (SEE DTL. 10A/10)</p> <p>19 CONCRETE EXPANSION JOINT - PLACE AGAINST ALL ADJACENT STRUCTURES</p> <p>20 CONCRETE CONTROL JOINT - PLACE 8'-0" ON CENTER - SEE PLAN</p> <p>21 EXISTING STOP SIGN TO REMAIN</p> <p>22 EXISTING PARKING SIGN TO REMAIN</p> <p>23 EXISTING ROOF DRAIN TO UNDERGROUND TO REMAIN</p> <p>24 EXISTING CONCRETE TRANSITION RAMP TO BE REMOVED AND REPLACE WITH A NEW CONCRETE TRANSITION RAMP OF THE SAME CONFIGURATION AS THAT OF THE EXISTING, BUT INTEGRAL WITH NEW SURROUNDING CONCRETE SIDEWALK</p> <p>25 EXISTING CONCRETE MARKER TO REMAIN - PROTECT</p> | <p>26 EXISTING FIRE HYDRANT TO REMAIN - PROTECT</p> <p>27 EXISTING PLYWOOD TRANSITION RAMP TO BE REMOVED, SALVAGED & RE-INSTALLED AFTER PLACEMENT OF NEW SIDEWALK</p> <p>28 EXISTING STONE STEP TO BE REMOVED, SALVAGED AND RE-INSTALLED AFTER PLACEMENT OF NEW SIDEWALK</p> <p>29 CONC. THRESHOLD RAMP</p> <p>30 NEW BENCH W/ BACK PROVIDED BY OWNER - INSTALLED BY CONTRACTOR - SEE DTL. 9A/10 (SIMILAR)</p> <p>31 EXISTING TRAFFIC SIGNAL POST TO REMAIN (PROTECT)</p> <p>32 EXISTING TRAFFIC SIGNAL CONTROL BOX TO REMAIN - ADJUST ELEVATION AS REQ'D TO BE FLUSH WITH NEW SIDEWALK</p> <p>33 REMOVE EXISTING LANDSCAPING, SHRUBS, BOULDERS, MULCH, ETC.</p> <p>34 EXISTING TREE - PROTECT</p> <p>35 REMOVE EXISTING BRICK PAVERS</p> <p>36 EXISTING FLAG POLE TO BE REMOVED, SALVAGED AND RE-INSTALLED ON A NEW CONCRETE BASE</p> <p>37 ASPHALT FILL</p> <p>38 REMOVE WOODEN PLANTER BOX</p> <p>39 EXISTING FIRE STANDPIPE TO REMAIN - PROTECT</p> <p>40 REMOVE EXISTING CROSS SIDEWALK DRAIN / COVER - INSTALL NEW CROSS SIDEWALK DRAIN / COVER - SEE DTL. 4A/10</p> | <p>41 EXISTING VETERANS' MEMORIAL SIGN - PROTECT</p> <p>42 EXISTING STREETS SIGN TO REMAIN</p> <p>43 DASHED LINE & HATCHED AREA INDICATES BASEMENT SPACE & WALL BELOW SIDEWALK. DO NOT REMOVE CONCRETE ABOVE BASEMENT WALL & SPACE BELOW. FIELD VERIFY EXACT EXTENT OF BASEMENT & CAREFULLY DEMOLISH AROUND PERIMETER. PROVIDE AN APPROXIMATELY 1" THICK CONCRETE OVERLAY OVER REMAINING EXISTING CONCRETE SLAB TO MATCH NEW CONSTRUCTION. BLEND SLOPE OF CONCRETE SIDEWALK TO TRANSITION WITH NEW ADJACENT CONCRETE CONSTRUCTION.</p> |
|---|--|--|--|

GENERAL NOTES

ALL NEW SIDEWALK & CURB ELEVATIONS / SLOPES TO REMAIN AS EXISTING EXCEPT AT CORNER CURB RAMP AND/OR UNLESS NOTED OTHERWISE.

ALL SIDEWALK CROSS SLOPES SHALL SLOPE (1/8" / FT. MIN.) - (1/4" / FT. MAX.) TOWARD STREET & AWAY FROM BUILDINGS

REMOVE EXISTING OVERHEAD ELECTRICAL AND PROVIDE NEW UNDERGROUND ELECTRICAL CONDUIT - SEE ELECTRICAL DWGS. FOR MORE INFO.

ALL EXISTING VALVE / COVERS, MANHOLES, DRAIN INLETS, ETC. SHALL BE ADJUSTED TO BE FLUSH WITH NEW CURB / SIDEWALK ELEVATIONS.

SCOPE OF WORK DEFINED BY SHADED AREA & HEAVY DASHED OUTLINE.

CONTRACTOR SHALL PROTECT ALL ADJACENT STRUCTURES, FIXTURES & PAVEMENTS AND BE FULLY RESPONSIBLE FOR DAMAGE BY CONTRACTOR.

CONTRACTOR SHALL BE REQUIRED TO SUPPLY ALL WARNING SIGNS AND BARRICADES NECESSARY FOR THE SAFETY OF THE GENERAL PUBLIC AND CONSTRUCTION PERSONNEL.

CONTRACTOR SHALL PROVIDE PEDESTRIAN ACCESS TO ALL BUILDINGS AT ALL TIMES DURING CONSTRUCTION. PEDESTRIAN BRIDGES, 4 FT. WIDE WITH RAILINGS 3 FT. HIGH SHALL BE PROVIDED BY THE CONTRACTOR TO PROVIDE ACCESS TO ALL BUILDINGS DURING SIDEWALK REPLACEMENT.

DELIVER PRODUCTS TO SITE IN MANUFACTURER'S ORIGINAL UNOPENED CONTAINERS AND PACKAGING. UPON DELIVERY, EXAMINE PACKAGES IMMEDIATELY TO ENSURE ALL PRODUCTS ARE COMPLETE AND UNDAMAGED. STORE PRODUCTS IN A PROTECTED, DRY AREA. PROTECT PRODUCTS FROM DAMAGE DURING HANDLING AND INSTALLATION.

CONTRACTOR SHALL SCHEDULE THE SIDEWALK REMOVAL SO THAT IT WILL HAVE THE LEAST INTERFERENCE WITH THE BUSINESSES INVOLVED.

ALL SIDEWALK CONCRETE TO BE 4 IN. THICK WITH 6x6 - W1.4xW1.4 WWF, EXCEPT ANY SIDEWALK THAT INTERSECTS A DRIVEWAY SHALL BE POURED 6 IN. THICK THROUGH THE DRIVE AND AT LEAST 4 FT. EITHER SIDE OF THE DRIVE.

PROTECT ADJACENT EXISTING ASPHALT PAVEMENT FROM DAMAGE DURING CONSTRUCTION. REPAIR / REPLACE ANY DAMAGED AREA AS REQUIRED.

ALL WORK TO COMPLY WITH:
ADA ACCESSIBILITY GUIDELINES
ILLINOIS ACCESSIBILITY CODE
INTERNATIONAL BUILDING CODE - 2006
NATIONAL ELECTRIC CODE - LATEST EDITION
CITY OF LITCHFIELD - CODE OF ORDINANCES

ABBREVIATIONS

U.N.O.	UNLESS NOTED OTHERWISE
DTL.	DETAIL
CONC.	CONCRETE
U.G.	UNDERGROUND
ELEC.	ELECTRIC
REDD.	REQUIRED
TYP.	TYPICAL
G.C.	GENERAL CONTRACTOR
SIM.	SIMILAR
R	RADIUS

FINAL REVIEW DRAWINGS - NOT FOR CONSTRUCTION

Illinois law requires anyone digging, regardless of the depth of the project, to call JULIE at 1-800-892-0123. This notice must be at least 48 hours/two working days prior to the start of excavation and the project must begin within 14 calendar days from the call.

NOTE: CONTRACTOR SHALL OBTAIN AND VERIFY ALL DIMENSIONS AND CONDITIONS AT JOB SITE AND BE FULLY RESPONSIBLE FOR SAME.

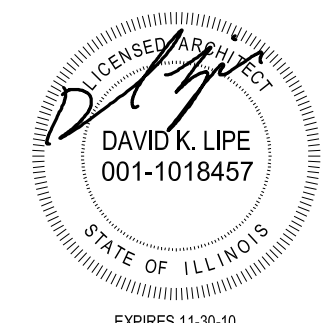

N 300 BLOCK STATE ST - EAST SIDE - SIDEWALK PLANS

City of Litchfield, Illinois - Downtown Streetscape - Phase 1

City of Litchfield, 120 E Ryder St, Litchfield, Illinois 62056

PROJ. NO.: 0809
DATE: 01-21-09
SHEET:
A4
SHEET 4 OF 11

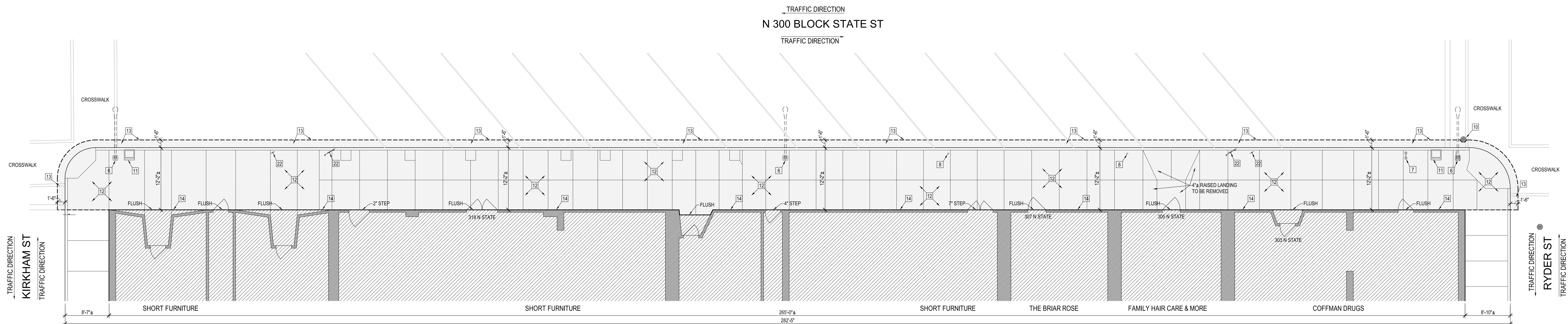

1 N 300 BLOCK STATE ST - WEST SIDE - SIDEWALK PLAN - DEMOLITION
SCALE: 1/8" = 1'-0"

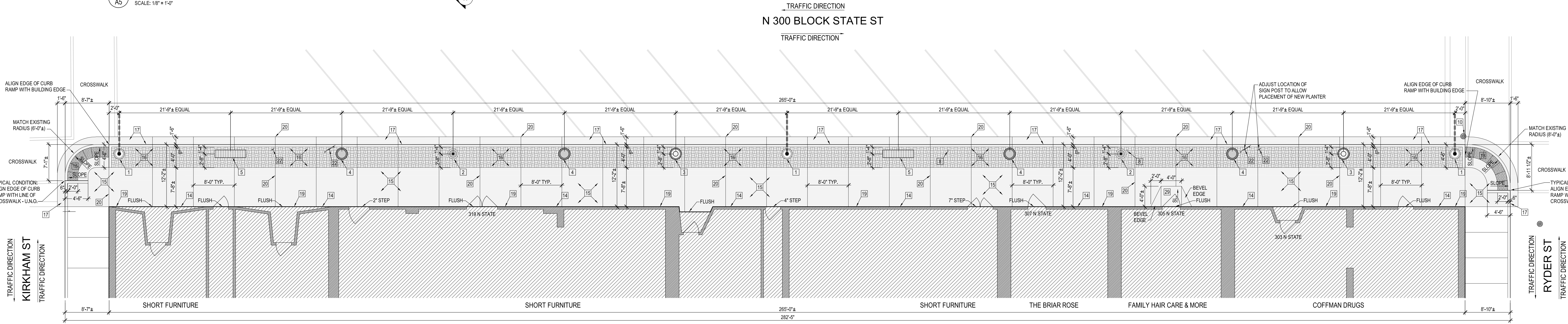

2 N 300 BLOCK STATE ST - WEST SIDE - SIDEWALK PLAN - NEW WORK
SCALE: 1/8" = 1'-0"

KEYED NOTES - (NOT ALL KEYED NOTES USED EACH SHEET)

- 1 NEW ORNAMENTAL STREET LIGHT - SEE DTL. 5/A10
PROVIDE NEW CONC. FOUNDATION & U.G. ELEC. SERVICE
- 2 NEW ORNAMENTAL LAMP POST - SEE DTL. 6/A10
PROVIDE NEW CONC. FOUNDATION & U.G. ELEC. SERVICE
- 3 NEW TRASH RECEPTACLE - SEE DTL. 7/A10
- 4 NEW PLANTER - SEE DTL. 8/A10
- 5 NEW BENCH - SEE DTL. 9/A10
- 6 EXISTING STREET LIGHT TO BE REMOVED - CAREFULLY REMOVE, SALVAGE & RE-INSTALL ALL EXISTING SIGNAGE ATTACHED TO POLE
- 7 EXISTING BIKE RACK TO BE REMOVED
- 8 EXISTING VALVE / COVER TO REMAIN - ADJUST ELEVATION AS REQ'D TO BE FLUSH WITH NEW SIDEWALK
- 9 EXISTING MANHOLE COVER TO REMAIN - ADJUST ELEVATION AS REQ'D TO BE FLUSH WITH NEW SIDEWALK
- 10 EXISTING DRAIN INLET TO REMAIN - ADJUST ELEVATION AS REQ'D TO BE FLUSH WITH NEW CURB / EXISTING PAVEMENT
- 11 EXISTING TRASH RECEPTACLE TO BE REMOVED
- 12 EXISTING CONCRETE SIDEWALK TO BE REMOVED
- 13 EXISTING ASPHALT PAVEMENT TO BE REMOVED - SAW CUT AS REQ'D FOR INSTALLATION OF NEW CONCRETE CURB / GUTTER
- 14 PROTECT ADJACENT EXISTING BUILDING
- 15 NEW PLAIN CONCRETE SIDEWALK WITH BROOM FINISH
- 16 NEW COLORED / STAMPED CONCRETE AMENITY STRIP
- 17 NEW CONCRETE CURB / GUTTER - SEE DTL. 1/A10
- 18 NEW DETECTABLE WARNING STRIP - SHALL BE 24" DEPTH x FULL WIDTH OF CURB RAMP. CAST-IN-PLACE POLYMER CONCRETE TILES, TRIM TO FIT RADIUS OF CURB. PROVIDE ALL ACCESSORIES AND INSTALL ACCORDING TO MANUFACTURER'S INSTRUCTIONS. ADA COMPLIANT TRUNCATED DOME TILES SHALL BE BRICK RED AS MANUFACTURED BY ONE OF THE COMPANIES BELOW:
1. DETECTABLE WARNING SYSTEMS, INC. - www.detectable-warning.com
2. DETECTILE CORP. - www.detectile.com
OR ARCHITECT APPROVED EQUAL (SEE DTL. 10/A10)
- 19 CONCRETE EXPANSION JOINT - PLACE AGAINST ALL ADJACENT STRUCTURES
- 20 CONCRETE CONTROL JOINT - PLACE 8'-0" ON CENTER - SEE PLAN
- 21 EXISTING STOP SIGN TO REMAIN
- 22 EXISTING PARKING SIGN TO REMAIN
- 23 EXISTING ROOF DRAIN TO UNDERGROUND TO REMAIN
- 24 EXISTING CONCRETE TRANSITION RAMP TO BE REMOVED AND REPLACE WITH A NEW CONCRETE TRANSITION RAMP OF THE SAME CONFIGURATION AS THAT OF THE EXISTING, BUT INTEGRAL WITH NEW SURROUNDING CONCRETE SIDEWALK
- 25 EXISTING CONCRETE MARKER TO REMAIN - PROTECT
- 26 EXISTING FIRE HYDRANT TO REMAIN - PROTECT
- 27 EXISTING PLYWOOD TRANSITION RAMP TO BE REMOVED, SALVAGED & RE-INSTALLED AFTER PLACEMENT OF NEW SIDEWALK
- 28 EXISTING STONE STEP TO BE REMOVED, SALVAGED AND RE-INSTALLED AFTER PLACEMENT OF NEW SIDEWALK
- 29 CONC. THRESHOLD RAMP
- 30 NEW BENCH W/ BACK PROVIDED BY OWNER - INSTALLED BY CONTRACTOR - SEE DTL. 9/A10 (SIMILAR)
- 31 EXISTING TRAFFIC SIGNAL POST TO REMAIN (PROTECT)
- 32 EXISTING TRAFFIC SIGNAL CONTROL BOX TO REMAIN - ADJUST ELEVATION AS REQ'D TO BE FLUSH WITH NEW SIDEWALK
- 33 REMOVE EXISTING LANDSCAPING, SHRUBS, BOULDERS, MULCH, ETC.
- 34 EXISTING TREE - PROTECT
- 35 REMOVE EXISTING BRICK PAVERS
- 36 EXISTING FLAG POLE TO BE REMOVED, SALVAGED AND RE-INSTALLED ON A NEW CONCRETE BASE
- 37 ASPHALT FILL
- 38 REMOVE WOODEN PLANTER BOX
- 39 EXISTING FIRE STANDPIPE TO REMAIN - PROTECT
- 40 REMOVE EXISTING CROSS SIDEWALK DRAIN / COVER - INSTALL NEW CROSS SIDEWALK DRAIN / COVER - SEE DTL. 4/A10
- 41 EXISTING VETERANS' MEMORIAL SIGN - PROTECT
- 42 EXISTING STREETS SIGN TO REMAIN
- 43 DASHED LINE & HATCHED AREA INDICATES BASEMENT SPACE & WALL BELOW SIDEWALK. DO NOT REMOVE CONCRETE ABOVE BASEMENT WALL & SPACE BELOW. FIELD VERIFY EXACT EXTENT OF BASEMENT & CAREFULLY DEMOLISH AROUND PERIMETER. PROVIDE AN APPROXIMATELY 1" THICK CONCRETE OVERLAY OVER REMAINING EXISTING CONCRETE SLAB TO MATCH NEW CONSTRUCTION. BLEND SLOPE OF CONCRETE SIDEWALK TO TRANSITION WITH NEW ADJACENT CONCRETE CONSTRUCTION.

GENERAL NOTES

ALL NEW SIDEWALK & CURB ELEVATIONS / SLOPES TO REMAIN AS EXISTING EXCEPT AT CORNER CURB RAMPS AND/OR UNLESS NOTED OTHERWISE.

ALL SIDEWALK CROSS SLOPES SHALL SLOPE (1/8" FT. MIN.) - (1/4" FT. MAX.) TOWARD STREET & AWAY FROM BUILDINGS

REMOVE EXISTING OVERHEAD ELECTRICAL AND PROVIDE NEW UNDERGROUND ELECTRICAL CONDUIT - SEE ELECTRICAL DWGS. FOR MORE INFO.

ALL EXISTING VALVE / COVERS, MANHOLES, DRAIN INLETS, ETC. SHALL BE ADJUSTED TO BE FLUSH WITH NEW CURB / SIDEWALKS ELEVATIONS.

SCOPE OF WORK DEFINED BY SHADED AREA & HEAVY DASHED OUTLINE.

CONTRACTOR SHALL PROTECT ALL ADJACENT STRUCTURES, FIXTURES & PAVEMENTS AND BE FULLY RESPONSIBLE FOR DAMAGE BY CONTRACTOR.

CONTRACTOR SHALL BE REQUIRED TO SUPPLY ALL WARNING SIGNS AND BARRICADES NECESSARY FOR THE SAFETY OF THE GENERAL PUBLIC AND CONSTRUCTION PERSONNEL.

CONTRACTOR SHALL PROVIDE PEDESTRIAN ACCESS TO ALL BUILDINGS AT ALL TIMES DURING CONSTRUCTION. PEDESTRIAN BRIDGES, 4 FT. WIDE WITH RAILINGS 3 FT. HIGH SHALL BE PROVIDED BY THE CONTRACTOR TO PROVIDE ACCESS TO ALL BUILDINGS DURING SIDEWALK REPLACEMENT.

DELIVER PRODUCTS TO SITE IN MANUFACTURER'S ORIGINAL UNOPENED CONTAINERS AND PACKAGING. UPON DELIVERY, EXAMINE PACKAGES IMMEDIATELY TO ENSURE ALL PRODUCTS ARE COMPLETE AND UNDAMAGED. STORE PRODUCTS IN A PROTECTED, DRY AREA. PROTECT PRODUCTS FROM DAMAGE DURING HANDLING AND INSTALLATION.

ABBREVIATIONS

U.N.O.	UNLESS NOTED OTHERWISE
DTL.	DETAIL
CONC.	CONCRETE
U.G.	UNDERGROUND
ELEC.	ELECTRIC
RECD.	REQUIRED
TYP.	TYPICAL
G.C.	GENERAL CONTRACTOR
SIM.	SIMILAR
R	RADIUS

FINAL REVIEW DRAWINGS - NOT FOR CONSTRUCTION

Illinois law requires anyone digging, regardless of the depth of the project, to call JULIE at 1-800-892-0123. This notice must be at least 48 hours/two working days prior to the start of excavation and the project must begin within 14 calendar days from the call.

NOTE: CONTRACTOR SHALL OBTAIN AND VERIFY ALL DIMENSIONS AND CONDITIONS AT JOB SITE AND BE FULLY RESPONSIBLE FOR SAME.

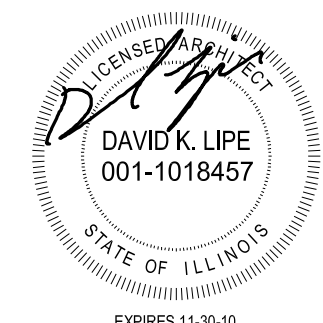

N 300 BLOCK STATE ST - WEST SIDE - SIDEWALK PLANS

City of Litchfield, Illinois - Downtown Streetscape - Phase 1

City of Litchfield, 120 E Ryder St, Litchfield, Illinois 62056

PROJ. NO.: 0809
DATE: 01-21-09
SHEET:
A5
SHEET 5 OF 11

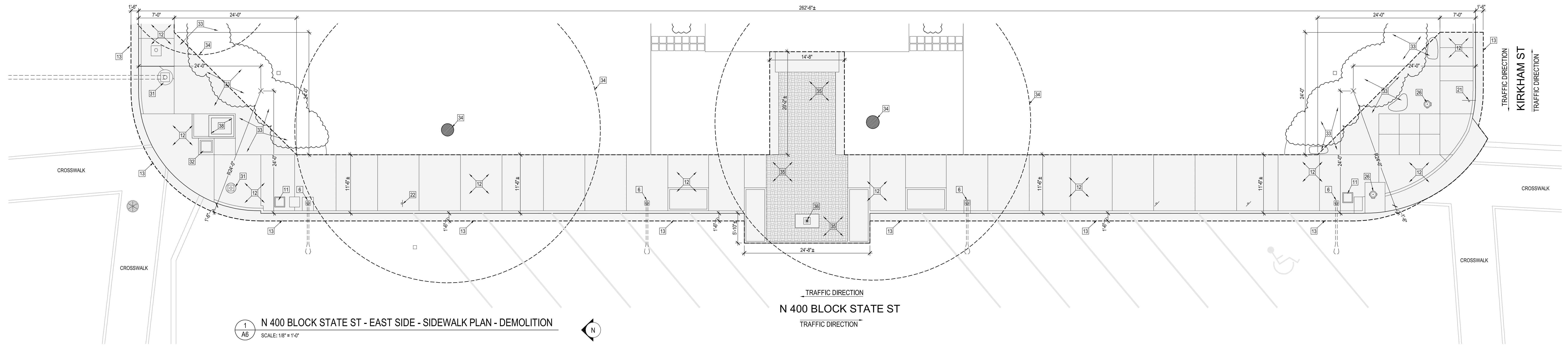

1 N 400 BLOCK STATE ST - EAST SIDE - SIDEWALK PLAN - DEMOLITION
SCALE: 1/8" = 1'-0"

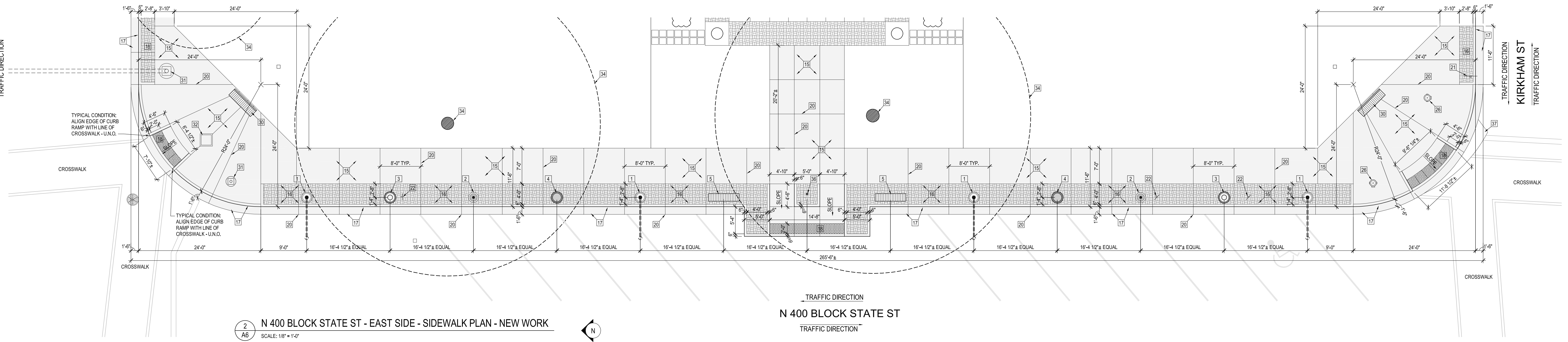

2 N 400 BLOCK STATE ST - EAST SIDE - SIDEWALK PLAN - NEW WORK
SCALE: 1/8" = 1'-0"

KEYED NOTES - (NOT ALL KEYED NOTES USED EACH SHEET)

- | | | | |
|---|---|--|--|
| <p>1 NEW ORNAMENTAL STREET LIGHT - SEE DTL. 5A/10
PROVIDE NEW CONC. FOUNDATION & U.G. ELEC. SERVICE</p> <p>2 NEW ORNAMENTAL LAMP POST - SEE DTL. 6A/10
PROVIDE NEW CONC. FOUNDATION & U.G. ELEC. SERVICE</p> <p>3 NEW TRASH RECEPTACLE - SEE DTL. 7A/10</p> <p>4 NEW PLANTER - SEE DTL. 8A/10</p> <p>5 NEW BENCH - SEE DTL. 9A/10</p> <p>6 EXISTING STREET LIGHT TO BE REMOVED - CAREFULLY REMOVE, SALVAGE & RE-INSTALL ALL EXISTING SIGNAGE ATTACHED TO POLE</p> <p>7 EXISTING BIKE RACK TO BE REMOVED</p> <p>8 EXISTING VALVE / COVER TO REMAIN - ADJUST ELEVATION AS REQ'D TO BE FLUSH WITH NEW SIDEWALK</p> <p>9 EXISTING MANHOLE COVER TO REMAIN - ADJUST ELEVATION AS REQ'D TO BE FLUSH WITH NEW SIDEWALK</p> <p>10 EXISTING DRAIN INLET TO REMAIN - ADJUST ELEVATION AS REQ'D TO BE FLUSH WITH NEW CURB / EXISTING PAVEMENT</p> <p>11 EXISTING TRASH RECEPTACLE TO BE REMOVED</p> <p>12 EXISTING CONCRETE SIDEWALK TO BE REMOVED</p> <p>13 EXISTING ASPHALT PAVEMENT TO BE REMOVED - SAW CUT AS REQ'D FOR INSTALLATION OF NEW CONCRETE CURB / GUTTER</p> | <p>14 PROTECT ADJACENT EXISTING BUILDING</p> <p>15 NEW PLAIN CONCRETE SIDEWALK WITH BROOM FINISH</p> <p>16 NEW COLORED / STAMPED CONCRETE AMENITY STRIP</p> <p>17 NEW CONCRETE CURB / GUTTER - SEE DTL. 1A/10</p> <p>18 NEW DETECTABLE WARNING STRIP - SHALL BE 24" DEPTH x FULL WIDTH OF CURB RAMP. CAST-IN-PLACE POLYMER CONCRETE TILES, TRIM TO FIT RADIUS OF CURB. PROVIDE ALL ACCESSORIES AND INSTALL ACCORDING TO MANUFACTURER'S INSTRUCTIONS. ADA COMPLIANT TRUNCATED DOME TILES SHALL BE: BRICK RED AS MANUFACTURED BY ONE OF THE COMPANIES BELOW:
1. DETECTABLE WARNING SYSTEMS, INC.: www.detectable-warning.com
2. DETECTILE CORP.: www.detectile.com
OR ARCHITECT APPROVED EQUAL (SEE DTL. 10A/10)</p> <p>19 CONCRETE EXPANSION JOINT - PLACE AGAINST ALL ADJACENT STRUCTURES</p> <p>20 CONCRETE CONTROL JOINT - PLACE 8'-0" ON CENTER - SEE PLAN</p> <p>21 EXISTING STOP SIGN TO REMAIN</p> <p>22 EXISTING PARKING SIGN TO REMAIN</p> <p>23 EXISTING ROOF DRAIN TO UNDERGROUND TO REMAIN</p> <p>24 EXISTING CONCRETE TRANSITION RAMP TO BE REMOVED AND REPLACE WITH A NEW CONCRETE TRANSITION RAMP OF THE SAME CONFIGURATION AS THAT OF THE EXISTING, BUT INTEGRAL WITH NEW SURROUNDING CONCRETE SIDEWALK</p> <p>25 EXISTING CONCRETE MARKER TO REMAIN - PROTECT</p> | <p>26 EXISTING FIRE HYDRANT TO REMAIN - PROTECT</p> <p>27 EXISTING PLYWOOD TRANSITION RAMP TO BE REMOVED, SALVAGED & RE-INSTALLED AFTER PLACEMENT OF NEW SIDEWALK</p> <p>28 EXISTING STONE STEP TO BE REMOVED, SALVAGED AND RE-INSTALLED AFTER PLACEMENT OF NEW SIDEWALK</p> <p>29 CONC. THRESHOLD RAMP</p> <p>30 NEW BENCH W/ BACK PROVIDED BY OWNER - INSTALLED BY CONTRACTOR - SEE DTL. 9A/10 (SIMILAR)</p> <p>31 EXISTING TRAFFIC SIGNAL POST TO REMAIN (PROTECT)</p> <p>32 EXISTING TRAFFIC SIGNAL CONTROL BOX TO REMAIN - ADJUST ELEVATION AS REQ'D TO BE FLUSH WITH NEW SIDEWALK</p> <p>33 REMOVE EXISTING LANDSCAPING, SHRUBS, BOULDERS, MULCH, ETC.</p> <p>34 EXISTING TREE - PROTECT</p> <p>35 REMOVE EXISTING BRICK PAVERS</p> <p>36 EXISTING FLAG POLE TO BE REMOVED, SALVAGED AND RE-INSTALLED ON A NEW CONCRETE BASE</p> <p>37 ASPHALT FILL</p> <p>38 REMOVE WOODEN PLANTER BOX</p> <p>39 EXISTING FIRE STANDPIPE TO REMAIN - PROTECT</p> <p>40 REMOVE EXISTING CROSS SIDEWALK DRAIN / COVER - INSTALL NEW CROSS SIDEWALK DRAIN / COVER - SEE DTL. 4A/10</p> | <p>41 EXISTING VETERANS' MEMORIAL SIGN - PROTECT</p> <p>42 EXISTING STREETS SIGN TO REMAIN</p> <p>43 DASHED LINE & HATCHED AREA INDICATES BASEMENT SPACE & WALL BELOW SIDEWALK. DO NOT REMOVE CONCRETE ABOVE BASEMENT WALL & SPACE BELOW. FIELD VERIFY EXACT EXTENT OF BASEMENT & CAREFULLY DEMOLISH AROUND PERIMETER. PROVIDE AN APPROXIMATELY 1" THICK CONCRETE OVERLAY OVER REMAINING EXISTING CONCRETE SLAB TO MATCH NEW CONSTRUCTION. BLEND SLOPE OF CONCRETE SIDEWALK TO TRANSITION WITH NEW ADJACENT CONCRETE CONSTRUCTION.</p> |
|---|---|--|--|

GENERAL NOTES

ALL NEW SIDEWALK & CURB ELEVATIONS / SLOPES TO REMAIN AS EXISTING EXCEPT AT CORNER CURB RAMP AND/OR UNLESS NOTED OTHERWISE.

ALL SIDEWALK CROSS SLOPES SHALL SLOPE (1/8" / FT. MIN.) - (1/4" / FT. MAX.) TOWARD STREET & AWAY FROM BUILDINGS

REMOVE EXISTING OVERHEAD ELECTRICAL AND PROVIDE NEW UNDERGROUND ELECTRICAL CONDUIT - SEE ELECTRICAL DWGS. FOR MORE INFO.

ALL EXISTING VALVE / COVERS, MANHOLES, DRAIN INLETS, ETC. SHALL BE ADJUSTED TO BE FLUSH WITH NEW CURB / SIDEWALK ELEVATIONS.

SCOPE OF WORK DEFINED BY SHADED AREA & HEAVY DASHED OUTLINE.

CONTRACTOR SHALL PROTECT ALL ADJACENT STRUCTURES, FIXTURES & PAVEMENTS AND BE FULLY RESPONSIBLE FOR DAMAGE BY CONTRACTOR.

CONTRACTOR SHALL BE REQUIRED TO SUPPLY ALL WARNING SIGNS AND BARRICADES NECESSARY FOR THE SAFETY OF THE GENERAL PUBLIC AND CONSTRUCTION PERSONNEL.

CONTRACTOR SHALL PROVIDE PEDESTRIAN ACCESS TO ALL BUILDINGS AT ALL TIMES DURING CONSTRUCTION. PEDESTRIAN BRIDGES, 4 FT. WIDE WITH RAILINGS 3 FT. HIGH SHALL BE PROVIDED BY THE CONTRACTOR TO PROVIDE ACCESS TO ALL BUILDINGS DURING SIDEWALK REPLACEMENT.

DELIVER PRODUCTS TO SITE IN MANUFACTURER'S ORIGINAL, UNOPENED CONTAINERS AND PACKAGING. UPON DELIVERY, EXAMINE PACKAGES IMMEDIATELY TO ENSURE ALL PRODUCTS ARE COMPLETE AND UNDAMAGED. STORE PRODUCTS IN A PROTECTED, DRY AREA. PROTECT PRODUCTS FROM DAMAGE DURING HANDLING AND INSTALLATION.

CONTRACTOR SHALL SCHEDULE THE SIDEWALK REMOVAL SO THAT IT WILL HAVE THE LEAST INTERFERENCE WITH THE BUSINESSES INVOLVED.

ALL SIDEWALK CONCRETE TO BE 4 IN. THICK WITH 606-W1.4W1.4 WWF, EXCEPT ANY SIDEWALK THAT INTERSECTS A DRIVEWAY SHALL BE POURED 6 IN. THICK THROUGH THE DRIVE AND AT LEAST 4 FT. EITHER SIDE OF THE DRIVE.

PROTECT ADJACENT EXISTING ASPHALT PAVEMENT FROM DAMAGE DURING CONSTRUCTION. REPAIR / REPLACE ANY DAMAGED AREA AS REQUIRED.

ALL WORK TO COMPLY WITH:
ADA ACCESSIBILITY GUIDELINES
ILLINOIS ACCESSIBILITY CODE
INTERNATIONAL BUILDING CODE - 2006
NATIONAL ELECTRIC CODE - LATEST EDITION
CITY OF LITCHFIELD - CODE OF ORDINANCES

ABBREVIATIONS

U.N.O.	UNLESS NOTED OTHERWISE
DTL.	DETAIL
CONC.	CONCRETE
U.G.	UNDERGROUND
ELEC.	ELECTRIC
RECD.	REQUIRED
TYP.	TYPICAL
G.C.	GENERAL CONTRACTOR
SIM.	SIMILAR
R	RADIUS

FINAL REVIEW DRAWINGS - NOT FOR CONSTRUCTION

Illinois law requires anyone digging, regardless of the depth of the project, to call JULIE at 1-800-892-0123. This notice must be at least 48 hours/two working days prior to the start of excavation and the project must begin within 14 calendar days from the call.

NOTE: CONTRACTOR SHALL OBTAIN AND VERIFY ALL DIMENSIONS AND CONDITIONS AT JOB SITE AND BE FULLY RESPONSIBLE FOR SAME.

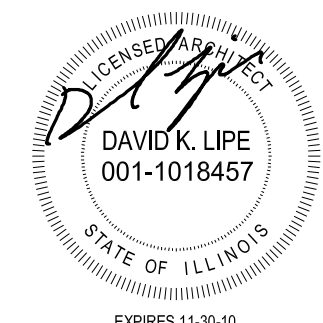

LIFE ARCHITECTURE
www.life-architecture.com
217-563-7638 phone
217-563-7643 fax

903 School Street
Nokomis, IL
62075

N 400 BLOCK STATE ST - EAST SIDE - SIDEWALK PLANS

City of Litchfield, Illinois - Downtown Streetscape - Phase 1

City of Litchfield, 120 E Ryder St, Litchfield, Illinois 62056

PROJ. NO.: 0809
DATE: 01-21-09
SHEET:
A6
SHEET 6 OF 11

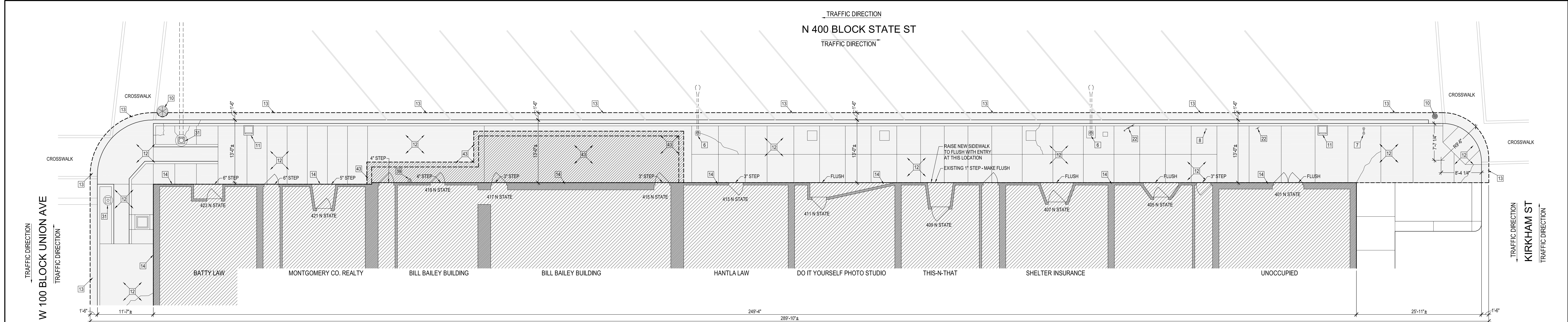

1 N 400 BLOCK STATE ST - WEST SIDE - SIDEWALK PLAN - DEMOLITION
SCALE: 1/8" = 1'-0"

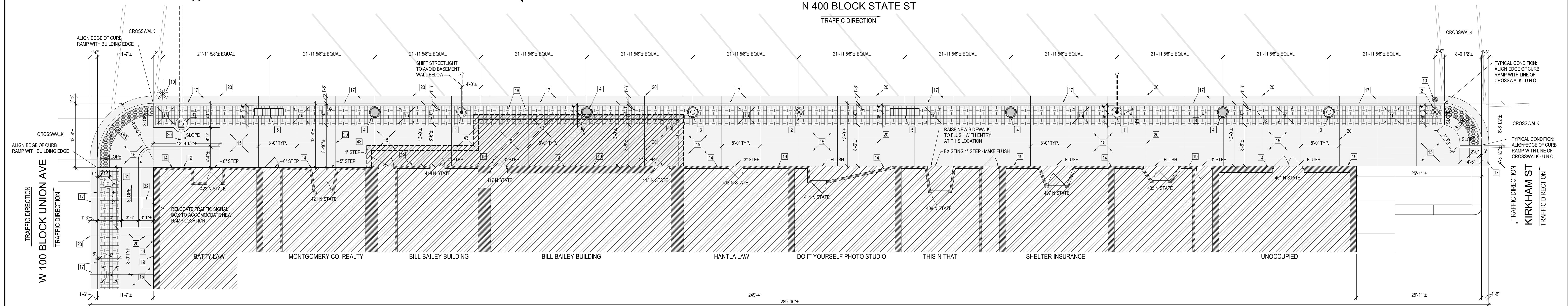

2 N 400 BLOCK STATE ST - WEST SIDE - SIDEWALK PLAN - NEW WORK
SCALE: 1/8" = 1'-0"

KEYED NOTES - (NOT ALL KEYED NOTES USED EACH SHEET)

- | | | | |
|---|---|--|--|
| <p>1 NEW ORNAMENTAL STREET LIGHT - SEE DTL. 5A/10 PROVIDE NEW CONC. FOUNDATION & U.G. ELEC. SERVICE</p> <p>2 NEW ORNAMENTAL LAMP POST - SEE DTL. 6A/10 PROVIDE NEW CONC. FOUNDATION & U.G. ELEC. SERVICE</p> <p>3 NEW TRASH RECEPTACLE - SEE DTL. 7A/10</p> <p>4 NEW PLANTER - SEE DTL. 9A/10</p> <p>5 NEW BENCH - SEE DTL. 9A/10</p> <p>6 EXISTING STREET LIGHT TO BE REMOVED - CAREFULLY REMOVE, SALVAGE & RE-INSTALL ALL EXISTING SIGNAGE ATTACHED TO POLE</p> <p>7 EXISTING BIKE RACK TO BE REMOVED</p> <p>8 EXISTING VALVE / COVER TO REMAIN - ADJUST ELEVATION AS REQ'D TO BE FLUSH WITH NEW SIDEWALK</p> <p>9 EXISTING MANHOLE COVER TO REMAIN - ADJUST ELEVATION AS REQ'D TO BE FLUSH WITH NEW SIDEWALK</p> <p>10 EXISTING DRAIN INLET TO REMAIN - ADJUST ELEVATION AS REQ'D TO BE FLUSH WITH NEW CURB / EXISTING PAVEMENT</p> <p>11 EXISTING TRASH RECEPTACLE TO BE REMOVED</p> <p>12 EXISTING CONCRETE SIDEWALK TO BE REMOVED</p> <p>13 EXISTING ASPHALT PAVEMENT TO BE REMOVED - SAW CUT AS REQ'D FOR INSTALLATION OF NEW CONCRETE CURB / GUTTER</p> | <p>14 PROTECT ADJACENT EXISTING BUILDING</p> <p>15 NEW PLAIN CONCRETE SIDEWALK WITH BROOM FINISH</p> <p>16 NEW COLORED / STAMPED CONCRETE AMENITY STRIP</p> <p>17 NEW CONCRETE CURB / GUTTER - SEE DTL. 1A/10</p> <p>18 NEW DETECTABLE WARNING STRIP - SHALL BE 24" DEPTH x FULL WIDTH OF CURB RAMP. CAST-IN-PLACE POLYMER CONCRETE TILES, TRIM TO FIT RADIUS OF CURB. PROVIDE ALL ACCESSORIES AND INSTALL ACCORDING TO MANUFACTURER'S INSTRUCTIONS. ADA COMPLIANT TRUNCATED DOME TILES SHALL BE: BRICK RED AS MANUFACTURED BY ONE OF THE COMPANIES BELOW:
1. DETECTABLE WARNING SYSTEMS, INC.: www.detectable-warning.com
2. DETECTILE CORP.: www.detectile.com
OR ARCHITECT APPROVED EQUAL (SEE DTL. 10A/10)</p> <p>19 CONCRETE EXPANSION JOINT - PLACE AGAINST ALL ADJACENT STRUCTURES</p> <p>20 CONCRETE CONTROL JOINT - PLACE 8'-0" ON CENTER - SEE PLAN</p> <p>21 EXISTING STOP SIGN TO REMAIN</p> <p>22 EXISTING PARKING SIGN TO REMAIN</p> <p>23 EXISTING ROOF DRAIN TO UNDERGROUND TO REMAIN</p> <p>24 EXISTING CONCRETE TRANSITION RAMP TO BE REMOVED AND REPLACE WITH A NEW CONCRETE TRANSITION RAMP OF THE SAME CONFIGURATION AS THAT OF THE EXISTING, BUT INTEGRAL WITH NEW SURROUNDING CONCRETE SIDEWALK</p> <p>25 EXISTING CONCRETE MARKER TO REMAIN - PROTECT</p> | <p>26 EXISTING FIRE HYDRANT TO REMAIN - PROTECT</p> <p>27 EXISTING PLYWOOD TRANSITION RAMP TO BE REMOVED, SALVAGED & RE-INSTALLED AFTER PLACEMENT OF NEW SIDEWALK</p> <p>28 EXISTING STONE STEP TO BE REMOVED, SALVAGED AND RE-INSTALLED AFTER PLACEMENT OF NEW SIDEWALK</p> <p>29 CONC. THRESHOLD RAMP</p> <p>30 NEW BENCH W/ BACK PROVIDED BY OWNER - INSTALLED BY CONTRACTOR - SEE DTL. 9A/10 (SIMILAR)</p> <p>31 EXISTING TRAFFIC SIGNAL POST TO REMAIN (PROTECT)</p> <p>32 EXISTING TRAFFIC SIGNAL CONTROL BOX TO REMAIN - ADJUST ELEVATION AS REQ'D TO BE FLUSH WITH NEW SIDEWALK</p> <p>33 REMOVE EXISTING LANDSCAPING, SHRUBS, BOULDERS, MULCH, ETC.</p> <p>34 EXISTING TREE - PROTECT</p> <p>35 REMOVE EXISTING BRICK PAVERS</p> <p>36 EXISTING FLAG POLE TO BE REMOVED, SALVAGED AND RE-INSTALLED ON A NEW CONCRETE BASE</p> <p>37 ASPHALT FILL</p> <p>38 REMOVE WOODEN PLANTER BOX</p> <p>39 EXISTING FIRE STANDPIPE TO REMAIN - PROTECT</p> <p>40 REMOVE EXISTING CROSS SIDEWALK DRAIN / COVER - INSTALL NEW CROSS SIDEWALK DRAIN / COVER - SEE DTL. 4A/10</p> | <p>41 EXISTING VETERANS' MEMORIAL SIGN - PROTECT</p> <p>42 EXISTING STREETS SIGN TO REMAIN</p> <p>43 DASHED LINE & HATCHED AREA INDICATES BASEMENT SPACE & WALL BELOW SIDEWALK. DO NOT REMOVE CONCRETE ABOVE BASEMENT WALL & SPACE BELOW. FIELD VERIFY EXACT EXTENT OF BASEMENT & CAREFULLY DEMOLISH AROUND PERIMETER. PROVIDE AN APPROXIMATELY 1" THICK CONCRETE OVERLAY OVER REMAINING EXISTING CONCRETE SLAB TO MATCH NEW CONSTRUCTION. BLEND SLOPE OF CONCRETE SIDEWALK TO TRANSITION WITH NEW ADJACENT CONCRETE CONSTRUCTION.</p> |
|---|---|--|--|

GENERAL NOTES

ALL NEW SIDEWALK & CURB ELEVATIONS / SLOPES TO REMAIN AS EXISTING EXCEPT AT CORNER CURB RAMPS AND/OR UNLESS NOTED OTHERWISE.

ALL SIDEWALK CROSS SLOPES SHALL SLOPE (1/8" / FT. MIN.) - (1/4" / FT. MAX.) TOWARD STREET & AWAY FROM BUILDINGS

REMOVE EXISTING OVERHEAD ELECTRICAL AND PROVIDE NEW UNDERGROUND ELECTRICAL CONDUIT - SEE ELECTRICAL DWGS. FOR MORE INFO.

ALL EXISTING VALVE / COVERS, MANHOLES, DRAIN INLETS, ETC. SHALL BE ADJUSTED TO BE FLUSH WITH NEW CURB / SIDEWALK ELEVATIONS.

SCOPE OF WORK DEFINED BY SHADED AREA & HEAVY DASHED OUTLINE.

CONTRACTOR SHALL PROTECT ALL ADJACENT STRUCTURES, FIXTURES & PAVEMENTS AND BE FULLY RESPONSIBLE FOR DAMAGE BY CONTRACTOR.

CONTRACTOR SHALL BE REQUIRED TO SUPPLY ALL WARNING SIGNS AND BARRICADES NECESSARY FOR THE SAFETY OF THE GENERAL PUBLIC AND CONSTRUCTION PERSONNEL.

CONTRACTOR SHALL PROVIDE PEDESTRIAN ACCESS TO ALL BUILDINGS AT ALL TIMES DURING CONSTRUCTION. PEDESTRIAN BRIDGES, 4 FT. WIDE WITH RAILINGS 3 FT. HIGH SHALL BE PROVIDED BY THE CONTRACTOR TO PROVIDE ACCESS TO ALL BUILDINGS DURING SIDEWALK REPLACEMENT.

DELIVER PRODUCTS TO SITE IN MANUFACTURER'S ORIGINAL, UNOPENED CONTAINERS AND PACKAGING. UPON DELIVERY, EXAMINE PACKAGES IMMEDIATELY TO ENSURE ALL PRODUCTS ARE COMPLETE AND UNDAMAGED. STORE PRODUCTS IN A PROTECTED, DRY AREA. PROTECT PRODUCTS FROM DAMAGE DURING HANDLING AND INSTALLATION.

ABBREVIATIONS

U.N.O.	UNLESS NOTED OTHERWISE
DTL.	DETAIL
CONC.	CONCRETE
U.G.	UNDERGROUND
ELEC.	ELECTRIC
RECD.	REQUIRED
TYP.	TYPICAL
G.C.	GENERAL CONTRACTOR
SIM.	SIMILAR
R	RADIUS

FINAL REVIEW DRAWINGS - NOT FOR CONSTRUCTION

Illinois law requires anyone digging, regardless of the depth of the project, to call JULIE at 1-800-892-0123. This notice must be at least 48 hours/two working days prior to the start of excavation and the project must begin within 14 calendar days from the call.

NOTE: CONTRACTOR SHALL OBTAIN AND VERIFY ALL DIMENSIONS AND CONDITIONS AT JOB SITE AND BE FULLY RESPONSIBLE FOR SAME.

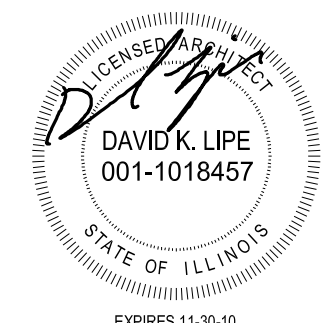

LIFE ARCHITECTURE
www.life-architecture.com
217-563-7638 phone
217-563-7643 fax
603 School Street
Naperville, IL 62075

N 400 BLOCK STATE ST - WEST SIDE - SIDEWALK PLANS

City of Litchfield, Illinois - Downtown Streetscape - Phase 1

City of Litchfield, 120 E Ryder St, Litchfield, Illinois 62056

PROJ. NO.: 0809
DATE: 01-21-09
SHEET:
A7
SHEET 7 OF 11

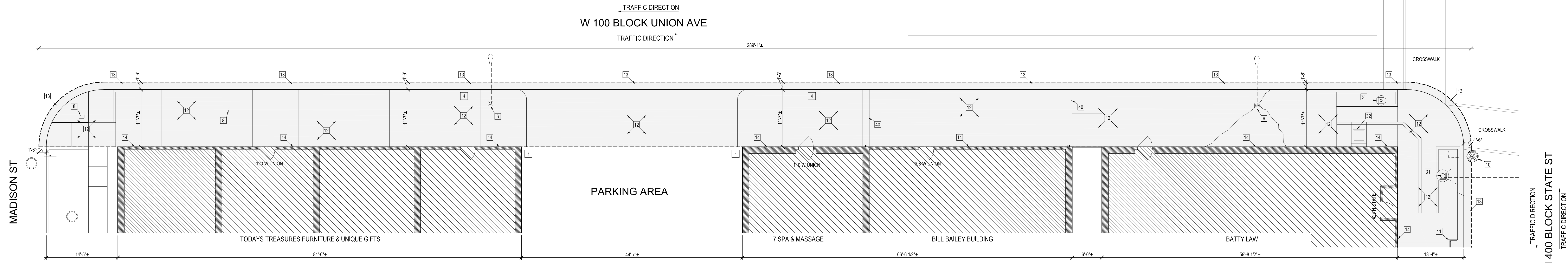

1 W 100 BLOCK UNION AVE - SOUTH SIDE - SIDEWALK PLAN - DEMOLITION
SCALE: 1/8" = 1'-0"

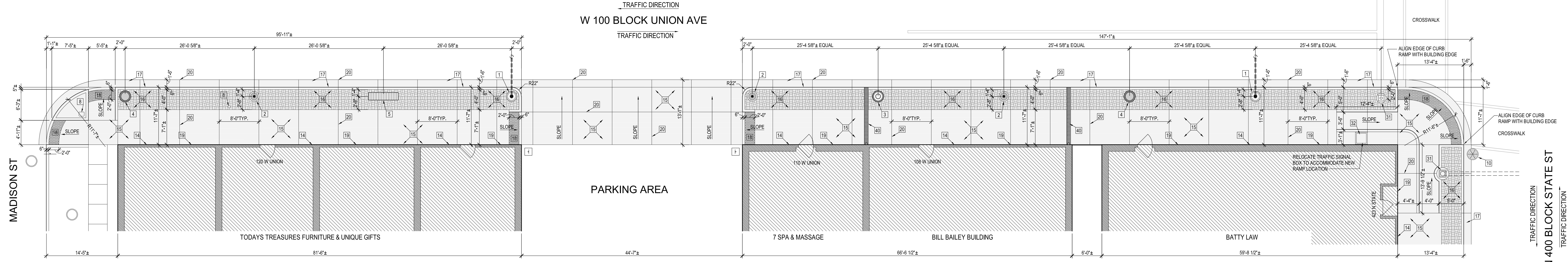

2 W 100 BLOCK UNION AVE - SOUTH SIDE - SIDEWALK PLAN - NEW WORK
SCALE: 1/8" = 1'-0"

KEYED NOTES - (NOT ALL KEYED NOTES USED EACH SHEET)

- | | | | |
|---|--|--|--|
| <p>1 NEW ORNAMENTAL STREET LIGHT - SEE DTL. 5/A10
PROVIDE NEW CONC. FOUNDATION & U.G. ELEC. SERVICE</p> <p>2 NEW ORNAMENTAL LAMP POST - SEE DTL. 6/A10
PROVIDE NEW CONC. FOUNDATION & U.G. ELEC. SERVICE</p> <p>3 NEW TRASH RECEPTACLE - SEE DTL. 7/A10</p> <p>4 NEW PLANTER - SEE DTL. 9/A10</p> <p>5 NEW BENCH - SEE DTL. 9/A10</p> <p>6 EXISTING STREET LIGHT TO BE REMOVED - CAREFULLY REMOVE, SALVAGE & RE-INSTALL ALL EXISTING SIGNAGE ATTACHED TO POLE</p> <p>7 EXISTING BIKE RACK TO BE REMOVED</p> <p>8 EXISTING VALVE / COVER TO REMAIN - ADJUST ELEVATION AS REQ'D TO BE FLUSH WITH NEW SIDEWALK</p> <p>9 EXISTING MANHOLE COVER TO REMAIN - ADJUST ELEVATION AS REQ'D TO BE FLUSH WITH NEW SIDEWALK</p> <p>10 EXISTING DRAIN INLET TO REMAIN - ADJUST ELEVATION AS REQ'D TO BE FLUSH WITH NEW CURB / EXISTING PAVEMENT</p> <p>11 EXISTING TRASH RECEPTACLE TO BE REMOVED</p> <p>12 EXISTING CONCRETE SIDEWALK TO BE REMOVED</p> <p>13 EXISTING ASPHALT PAVEMENT TO BE REMOVED - SAW CUT AS REQ'D FOR INSTALLATION OF NEW CONCRETE CURB / GUTTER</p> | <p>14 PROTECT ADJACENT EXISTING BUILDING</p> <p>15 NEW PLAIN CONCRETE SIDEWALK WITH BROOM FINISH</p> <p>16 NEW COLORED / STAMPED CONCRETE AMENITY STRIP</p> <p>17 NEW CONCRETE CURB / GUTTER - SEE DTL. 1/A10</p> <p>18 NEW DETECTABLE WARNING STRIP - SHALL BE 2" DEPTH x FULL WIDTH OF CURB RAMP. CAST-IN-PLACE POLYMER CONCRETE TILES, TRIM TO FIT RADIUS OF CURB. PROVIDE ALL ACCESSORIES AND INSTALL ACCORDING TO MANUFACTURER'S INSTRUCTIONS. ADA COMPLIANT TRUNCATED DOME TILES SHALL BE: BRICK RED AS MANUFACTURED BY ONE OF THE COMPANIES BELOW:
1. DETECTABLE WARNING SYSTEMS, INC. - www.detectable-warning.com
2. DETECTILE CORP. - www.detectile.com
OR ARCHITECT APPROVED EQUAL (SEE DTL. 10/A10)</p> <p>19 CONCRETE EXPANSION JOINT - PLACE AGAINST ALL ADJACENT STRUCTURES</p> <p>20 CONCRETE CONTROL JOINT - PLACE 8'-0" ON CENTER - SEE PLAN</p> <p>21 EXISTING STOP SIGN TO REMAIN</p> <p>22 EXISTING PARKING SIGN TO REMAIN</p> <p>23 EXISTING ROOF DRAIN TO UNDERGROUND TO REMAIN</p> <p>24 EXISTING CONCRETE TRANSITION RAMP TO BE REMOVED AND REPLACE WITH A NEW CONCRETE TRANSITION RAMP OF THE SAME CONFIGURATION AS THAT OF THE EXISTING, BUT INTEGRAL WITH NEW SURROUNDING CONCRETE SIDEWALK</p> <p>25 EXISTING CONCRETE MARKER TO REMAIN - PROTECT</p> | <p>26 EXISTING FIRE HYDRANT TO REMAIN - PROTECT</p> <p>27 EXISTING PLYWOOD TRANSITION RAMP TO BE REMOVED, SALVAGED & RE-INSTALLED AFTER PLACEMENT OF NEW SIDEWALK</p> <p>28 EXISTING STONE STEP TO BE REMOVED, SALVAGED AND RE-INSTALLED AFTER PLACEMENT OF NEW SIDEWALK</p> <p>29 CONC. THRESHOLD RAMP</p> <p>30 NEW BENCH W/ BACK PROVIDED BY OWNER - INSTALLED BY CONTRACTOR - SEE DTL. 9/A10 (SIMILAR)</p> <p>31 EXISTING TRAFFIC SIGNAL POST TO REMAIN (PROTECT)</p> <p>32 EXISTING TRAFFIC SIGNAL CONTROL BOX TO REMAIN - ADJUST ELEVATION AS REQ'D TO BE FLUSH WITH NEW SIDEWALK</p> <p>33 REMOVE EXISTING LANDSCAPING, SHRUBS, BOULDERS, MULCH, ETC.</p> <p>34 EXISTING TREE - PROTECT</p> <p>35 REMOVE EXISTING BRICK PAVERS</p> <p>36 EXISTING FLAG POLE TO BE REMOVED, SALVAGED AND RE-INSTALLED ON A NEW CONCRETE BASE</p> <p>37 ASPHALT FILL</p> <p>38 REMOVE WOODEN PLANTER BOX</p> <p>39 EXISTING FIRE STANDPIPE TO REMAIN - PROTECT</p> <p>40 REMOVE EXISTING CROSS SIDEWALK DRAIN / COVER - INSTALL NEW CROSS SIDEWALK DRAIN / COVER - SEE DTL. 4/A10</p> | <p>41 EXISTING VETERANS' MEMORIAL SIGN - PROTECT</p> <p>42 EXISTING STREETS SIGN TO REMAIN</p> <p>43 DASHED LINE & HATCHED AREA INDICATES BASEMENT SPACE & WALL BELOW SIDEWALK. DO NOT REMOVE CONCRETE ABOVE BASEMENT WALL & SPACE BELOW. FIELD VERIFY EXACT EXTENT OF BASEMENT & CAREFULLY DEMOLISH AROUND PERIMETER. PROVIDE AN APPROXIMATELY 1" THICK CONCRETE OVERLAY OVER REMAINING EXISTING CONCRETE SLAB TO MATCH NEW CONSTRUCTION. BLEND SLOPE OF CONCRETE SIDEWALK TO TRANSITION WITH NEW ADJACENT CONCRETE CONSTRUCTION.</p> |
|---|--|--|--|

GENERAL NOTES

ALL NEW SIDEWALK & CURB ELEVATIONS / SLOPES TO REMAIN AS EXISTING EXCEPT AT CORNER CURB RAMP AND/OR UNLESS NOTED OTHERWISE.

ALL SIDEWALK CROSS SLOPES SHALL SLOPE (1/8" / FT. MIN.) - (1/4" / FT. MAX.) TOWARD STREET & AWAY FROM BUILDINGS

REMOVE EXISTING OVERHEAD ELECTRICAL AND PROVIDE NEW UNDERGROUND ELECTRICAL CONDUIT - SEE ELECTRICAL DWGS. FOR MORE INFO.

ALL EXISTING VALVE / COVERS, MANHOLES, DRAIN INLETS, ETC. SHALL BE ADJUSTED TO BE FLUSH WITH NEW CURB / SIDEWALKS ELEVATIONS.

SCOPE OF WORK DEFINED BY SHADED AREA & HEAVY DASHED OUTLINE.

CONTRACTOR SHALL PROTECT ALL ADJACENT STRUCTURES, FIXTURES & PAVEMENTS AND BE FULLY RESPONSIBLE FOR DAMAGE BY CONTRACTOR.

CONTRACTOR SHALL BE REQUIRED TO SUPPLY ALL WARNING SIGNS AND BARRICADES NECESSARY FOR THE SAFETY OF THE GENERAL PUBLIC AND CONSTRUCTION PERSONNEL.

CONTRACTOR SHALL PROVIDE PEDESTRIAN ACCESS TO ALL BUILDINGS AT ALL TIMES DURING CONSTRUCTION. PEDESTRIAN BRIDGES, 4 FT. WIDE WITH RAILINGS 3 FT. HIGH SHALL BE PROVIDED BY THE CONTRACTOR TO PROVIDE ACCESS TO ALL BUILDINGS DURING SIDEWALK REPLACEMENT.

DELIVER PRODUCTS TO SITE IN MANUFACTURER'S ORIGINAL UNOPENED CONTAINERS AND PACKAGING. UPON DELIVERY, EXAMINE PACKAGES IMMEDIATELY TO ENSURE ALL PRODUCTS ARE COMPLETE AND UNDAMAGED. STORE PRODUCTS IN A PROTECTED, DRY AREA. PROTECT PRODUCTS FROM DAMAGE DURING HANDLING AND INSTALLATION.

CONTRACTOR SHALL SCHEDULE THE SIDEWALK REMOVAL SO THAT IT WILL HAVE THE LEAST INTERFERENCE WITH THE BUSINESSES INVOLVED.

ALL SIDEWALK CONCRETE TO BE 4 IN. THICK WITH 6x6 - W1.4W1.4 WWF, EXCEPT ANY SIDEWALK THAT INTERSECTS A DRIVEWAY SHALL BE POURED 6 IN. THICK THROUGH THE DRIVE AND AT LEAST 4 FT. EITHER SIDE OF THE DRIVE.

PROTECT ADJACENT EXISTING ASPHALT PAVEMENT FROM DAMAGE DURING CONSTRUCTION. REPAIR / REPLACE ANY DAMAGED AREA AS REQUIRED.

ABBREVIATIONS

U.N.O.	UNLESS NOTED OTHERWISE
DTL.	DETAIL
CONC.	CONCRETE
U.G.	UNDERGROUND
ELEC.	ELECTRIC
RECD.	REQUIRED
TYP.	TYPICAL
G.C.	GENERAL CONTRACTOR
SIM.	SIMILAR
R	RADIUS

FINAL REVIEW DRAWINGS - NOT FOR CONSTRUCTION

Illinois law requires anyone digging, regardless of the depth of the project, to call JULIE at 1-800-892-0123. This notice must be at least 48 hours/two working days prior to the start of excavation and the project must begin within 14 calendar days from the call.

NOTE: CONTRACTOR SHALL OBTAIN AND VERIFY ALL DIMENSIONS AND CONDITIONS AT JOB SITE AND BE FULLY RESPONSIBLE FOR SAME.

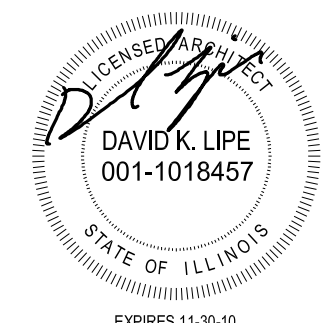

LIFE ARCHITECTURE
www.life-architecture.com
217-563-7636 phone
217-563-7643 fax
903 School Street
Nokomis, IL
62075

W 100 BLOCK UNION AVE - SOUTH SIDE - SIDEWALK PLANS
City of Litchfield, Illinois - Downtown Streetscape - Phase 1
City of Litchfield, 120 E Ryder St, Litchfield, Illinois 62056

PROJ. NO.: 0809
DATE: 01-21-09
SHEET:
A8
SHEET 8 OF 11

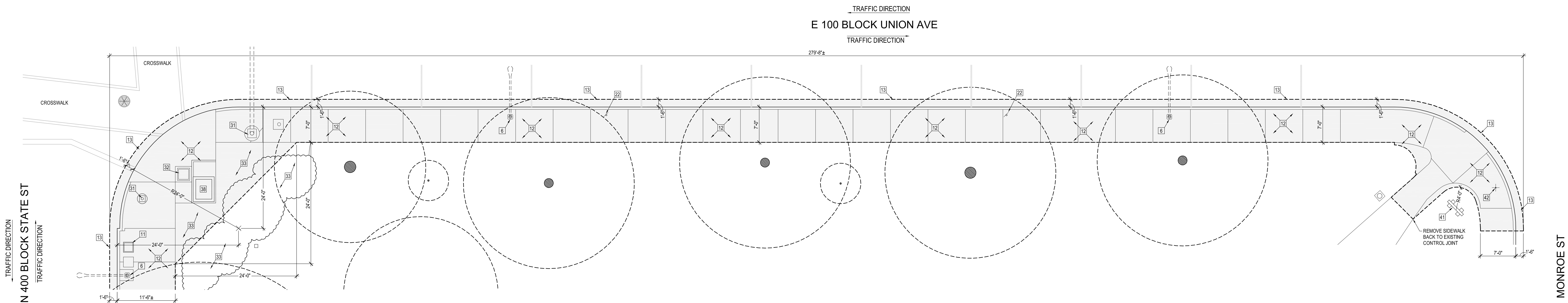

1 E 100 BLOCK UNION AVE - SOUTH SIDE - SIDEWALK PLAN - DEMOLITION
SCALE: 1/8" = 1'-0"

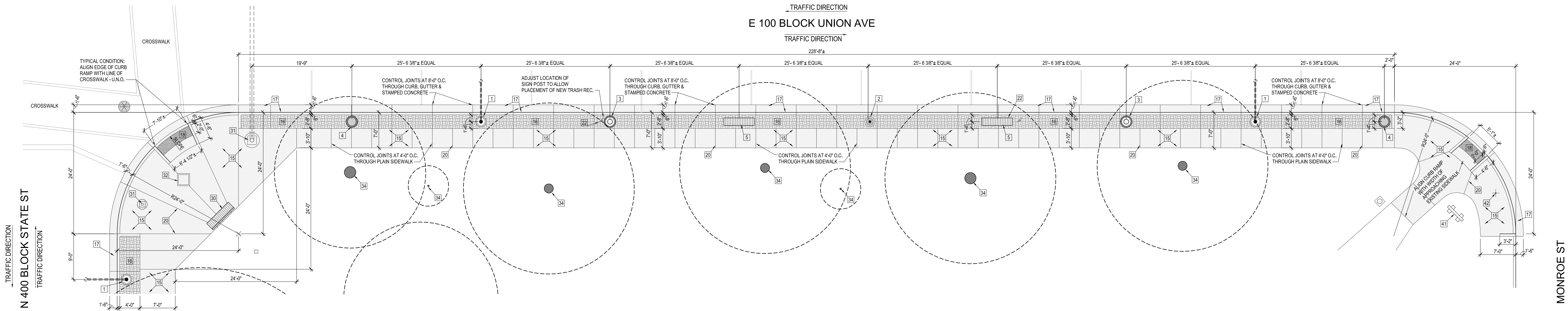

2 E 100 BLOCK UNION AVE - SOUTH SIDE - SIDEWALK PLAN - NEW WORK
SCALE: 1/8" = 1'-0"

KEYED NOTES - (NOT ALL KEYED NOTES USED EACH SHEET)

- | | | | |
|--|---|---|---|
| 1 NEW ORNAMENTAL STREET LIGHT - SEE DTL 5A10
PROVIDE NEW CONC. FOUNDATION & U.G. ELEC. SERVICE | 14 PROTECT ADJACENT EXISTING BUILDING | 26 EXISTING FIRE HYDRANT TO REMAIN - PROTECT | 41 EXISTING VETERANS' MEMORIAL SIGN - PROTECT |
| 2 NEW ORNAMENTAL LAMP POST - SEE DTL 6A10
PROVIDE NEW CONC. FOUNDATION & U.G. ELEC. SERVICE | 15 NEW PLAIN CONCRETE SIDEWALK WITH BROOM FINISH | 27 EXISTING PLYWOOD TRANSITION RAMP TO BE REMOVED,
SALVAGED & RE-INSTALLED AFTER PLACEMENT OF NEW SIDEWALK | 42 EXISTING STREETS SIGN TO REMAIN |
| 3 NEW TRASH RECEPTACLE - SEE DTL 7A10 | 16 NEW COLORED / STAMPED CONCRETE AMENITY STRIP | 28 EXISTING STONE STEP TO BE REMOVED, SALVAGED AND
RE-INSTALLED AFTER PLACEMENT OF NEW SIDEWALK | 43 DASHED LINE & HATCHED AREA INDICATES
BASEMENT SPACE & WALL BELOW SIDEWALK.
DO NOT REMOVE CONCRETE ABOVE BASEMENT
WALL & SPACE BELOW. FIELD VERIFY EXACT EXTENT
OF BASEMENT & CAREFULLY DEMOLISH AROUND
PERIMETER. PROVIDE AN APPROXIMATELY 1" THICK
CONCRETE OVERLAY OVER REMAINING EXISTING
CONCRETE SLAB TO MATCH NEW CONSTRUCTION.
BLEND SLOPE OF CONCRETE SIDEWALK TO TRANSITION
WITH NEW ADJACENT CONCRETE CONSTRUCTION. |
| 4 NEW PLANTER - SEE DTL 9A10 | 17 NEW CONCRETE CURB / GUTTER - SEE DTL 1A10 | 29 CONC. THRESHOLD RAMP | |
| 5 NEW BENCH - SEE DTL 9A10 | 18 NEW DETECTABLE WARNING STRIP - SHALL BE 24" DEPTH x FULL WIDTH
OF CURB RAMP. CAST-IN-PLACE POLYMER CONCRETE TILES, TRIM TO
FIT RADIUS OF CURB. PROVIDE ALL ACCESSORIES AND INSTALL ACCORDING
TO MANUFACTURER'S INSTRUCTIONS. ADA COMPLIANT TRUNCATED DOME TILES
SHALL BE BRICK RED AS MANUFACTURED BY ONE OF THE COMPANIES BELOW:
1. DETECTABLE WARNING SYSTEMS, INC. - www.detectable-warning.com
2. DETECTILE CORP. - www.detectile.com
OR ARCHITECT APPROVED EQUAL (SEE DTL 10A10) | 30 NEW BENCH W/ BACK PROVIDED BY OWNER
INSTALLED BY CONTRACTOR - SEE DTL 9A10 (SIMILAR) | |
| 6 EXISTING STREET LIGHT TO BE REMOVED -
CAREFULLY REMOVE, SALVAGE & RE-INSTALL
ALL EXISTING SIGNAGE ATTACHED TO POLE | 19 CONCRETE EXPANSION JOINT - PLACE AGAINST ALL ADJACENT STRUCTURES | 31 EXISTING TRAFFIC SIGNAL POST TO REMAIN (PROTECT) | |
| 7 EXISTING BIKE RACK TO BE REMOVED | 20 CONCRETE CONTROL JOINT - PLACE 8'-0" ON CENTER - SEE PLAN | 32 EXISTING TRAFFIC SIGNAL CONTROL BOX TO REMAIN - ADJUST
ELEVATION AS REQ'D TO BE FLUSH WITH NEW SIDEWALK | |
| 8 EXISTING VALVE / COVER TO REMAIN - ADJUST
ELEVATION AS REQ'D TO BE FLUSH WITH NEW SIDEWALK | 21 EXISTING STOP SIGN TO REMAIN | 33 REMOVE EXISTING LANDSCAPING, SHRUBS, BOULDERS, MULCH, ETC. | |
| 9 EXISTING MANHOLE COVER TO REMAIN - ADJUST
ELEVATION AS REQ'D TO BE FLUSH WITH NEW SIDEWALK | 22 EXISTING PARKING SIGN TO REMAIN | 34 EXISTING TREE - PROTECT | |
| 10 EXISTING DRAIN INLET TO REMAIN - ADJUST ELEVATION
AS REQ'D TO BE FLUSH WITH NEW CURB / EXISTING PAVEMENT | 23 EXISTING ROOF DRAIN TO UNDERGROUND TO REMAIN | 35 REMOVE EXISTING BRICK PAVERS | |
| 11 EXISTING TRASH RECEPTACLE TO BE REMOVED | 24 EXISTING CONCRETE TRANSITION RAMP TO BE REMOVED AND
REPLACE WITH A NEW CONCRETE TRANSITION RAMP OF THE SAME
CONFIGURATION AS THAT OF THE EXISTING, BUT INTEGRAL WITH
NEW SURROUNDING CONCRETE SIDEWALK | 36 EXISTING FLAG POLE TO BE REMOVED, SALVAGED AND
RE-INSTALLED ON A NEW CONCRETE BASE | |
| 12 EXISTING CONCRETE SIDEWALK TO BE REMOVED | 25 EXISTING CONCRETE MARKER TO REMAIN - PROTECT | 37 ASPHALT FILL | |
| 13 EXISTING ASPHALT PAVEMENT TO BE REMOVED - SAW CUT AS
REQ'D FOR INSTALLATION OF NEW CONCRETE CURB / GUTTER | | 38 REMOVE WOODEN PLANTER BOX | |
| | | 39 EXISTING FIRE STANDPIPE TO REMAIN - PROTECT | |
| | | 40 REMOVE EXISTING CROSS SIDEWALK DRAIN / COVER -
INSTALL NEW CROSS SIDEWALK DRAIN / COVER - SEE DTL 4A10 | |

GENERAL NOTES

ALL NEW SIDEWALK & CURB ELEVATIONS / SLOPES TO REMAIN AS EXISTING EXCEPT AT CORNER CURB RAMP AND/OR UNLESS NOTED OTHERWISE.

ALL SIDEWALK CROSS SLOPES SHALL SLOPE (1/8" / FT. MIN.) - (1/4" / FT. MAX.) TOWARD STREET & AWAY FROM BUILDINGS

REMOVE EXISTING OVERHEAD ELECTRICAL AND PROVIDE NEW UNDERGROUND ELECTRICAL CONDUIT - SEE ELECTRICAL DWGS. FOR MORE INFO.

ALL EXISTING VALVE / COVERS, MANHOLES, DRAIN INLETS, ETC. SHALL BE ADJUSTED TO BE FLUSH WITH NEW CURB / SIDEWALKS ELEVATIONS.

SCOPE OF WORK DEFINED BY SHADED AREA & HEAVY DASHED OUTLINE.

CONTRACTOR SHALL PROTECT ALL ADJACENT STRUCTURES, FIXTURES & PAVEMENTS AND BE FULLY RESPONSIBLE FOR DAMAGE BY CONTRACTOR.

CONTRACTOR SHALL BE REQUIRED TO SUPPLY ALL WARNING SIGNS AND BARRICADES NECESSARY FOR THE SAFETY OF THE GENERAL PUBLIC AND CONSTRUCTION PERSONNEL.

CONTRACTOR SHALL PROVIDE PEDESTRIAN ACCESS TO ALL BUILDINGS AT ALL TIMES DURING CONSTRUCTION. PEDESTRIAN BRIDGES, 4 FT. WIDE WITH RAILINGS 3 FT. HIGH SHALL BE PROVIDED BY THE CONTRACTOR TO PROVIDE ACCESS TO ALL BUILDINGS DURING SIDEWALK REPLACEMENT.

DELIVER PRODUCTS TO SITE IN MANUFACTURER'S ORIGINAL, UNOPENED CONTAINERS AND PACKAGING. UPON DELIVERY, EXAMINE PACKAGES IMMEDIATELY TO ENSURE ALL PRODUCTS ARE COMPLETE AND UNDAMAGED. STORE PRODUCTS IN A PROTECTED, DRY AREA. PROTECT PRODUCTS FROM DAMAGE DURING HANDLING AND INSTALLATION.

CONTRACTOR SHALL SCHEDULE THE SIDEWALK REMOVAL SO THAT IT WILL HAVE THE LEAST INTERFERENCE WITH THE BUSINESSES INVOLVED.

ALL SIDEWALK CONCRETE TO BE 4 IN. THICK WITH 6x6 - W1.4xW1.4 WWF, EXCEPT ANY SIDEWALK THAT INTERSECTS A DRIVEWAY SHALL BE POURED 6 IN. THICK THROUGH THE DRIVE AND AT LEAST 4 FT. EITHER SIDE OF THE DRIVE.

PROTECT ADJACENT EXISTING ASPHALT PAVEMENT FROM DAMAGE DURING CONSTRUCTION. REPAIR / REPLACE ANY DAMAGED AREA AS REQUIRED.

ALL WORK TO COMPLY WITH:
ADA ACCESSIBILITY GUIDELINES
ILLINOIS ACCESSIBILITY CODE
INTERNATIONAL BUILDING CODE - 2006
NATIONAL ELECTRIC CODE - LATEST EDITION
CITY OF LITCHFIELD - CODE OF ORDINANCES

ABBREVIATIONS

U.N.O.	UNLESS NOTED OTHERWISE
DTL	DETAIL
CONC.	CONCRETE
U.G.	UNDERGROUND
ELEC.	ELECTRIC
RECD.	REQUIRED
TYP.	TYPICAL
G.C.	GENERAL CONTRACTOR
SIM.	SIMILAR
R	RADIUS

FINAL REVIEW DRAWINGS - NOT FOR CONSTRUCTION

Illinois law requires anyone digging, regardless of the depth of the project, to call JULIE at 1-800-892-0123. This notice must be at least 48 hours/two working days prior to the start of excavation and the project must begin within 14 calendar days from the call.

NOTE: CONTRACTOR SHALL OBTAIN AND VERIFY ALL DIMENSIONS AND CONDITIONS AT JOB SITE AND BE FULLY RESPONSIBLE FOR SAME.

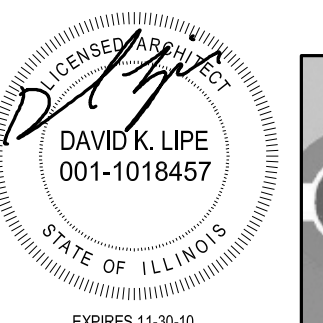

LIFE ARCHITECTURE
www.life-architecture.com
217-563-7638 phone
217-563-7643 fax
803 School Street
Naperville, IL 62075

E 100 BLOCK UNION AVE - SOUTH SIDE - SIDEWALK PLANS
City of Litchfield, Illinois - Downtown Streetscape - Phase 1
City of Litchfield, 120 E Ryder St, Litchfield, Illinois 62056

PROJ. NO.: 0809
DATE: 01-21-09
SHEET:
A9
SHEET 9 OF 11

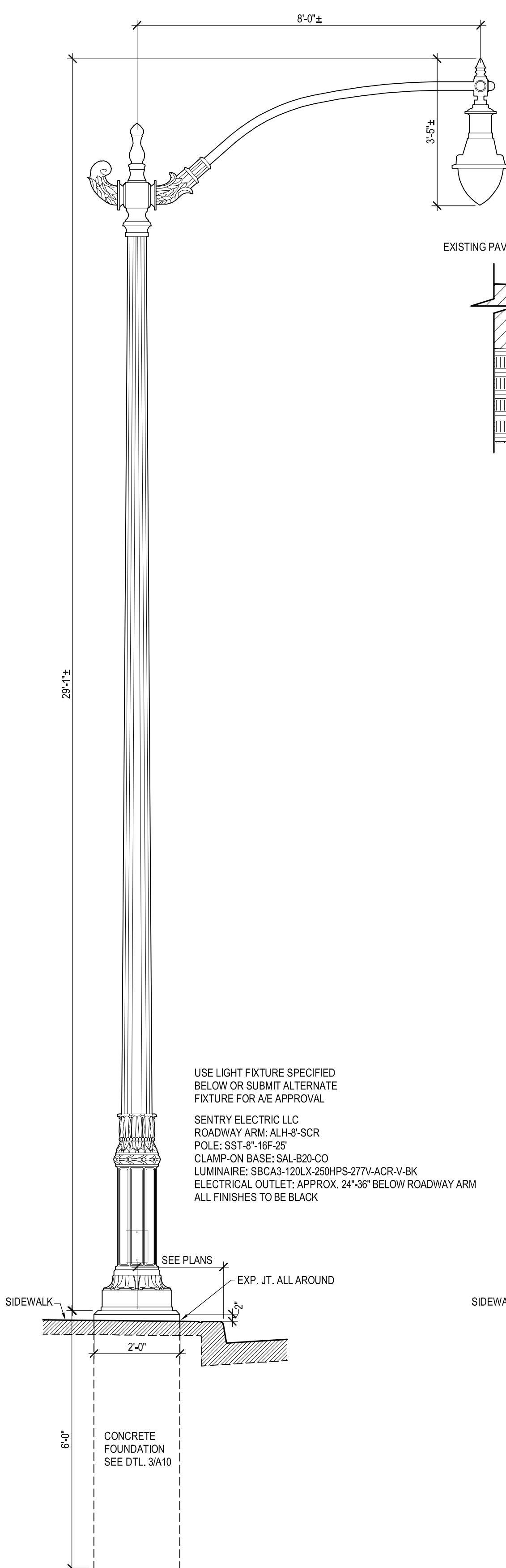

5 STREET LIGHT
SCALE: 1/2" = 1'-0"

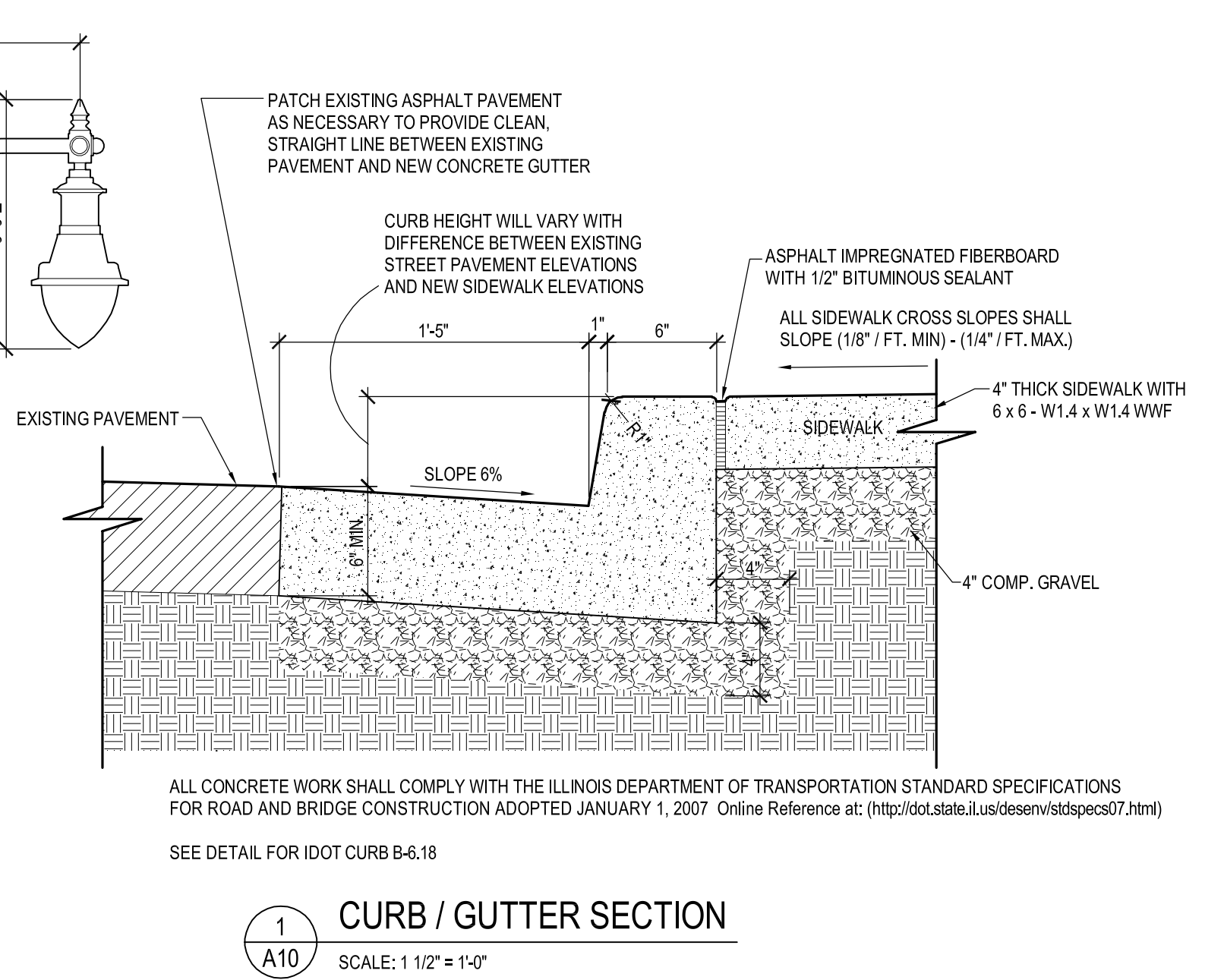

1 CURB / GUTTER SECTION
SCALE: 1 1/2" = 1'-0"

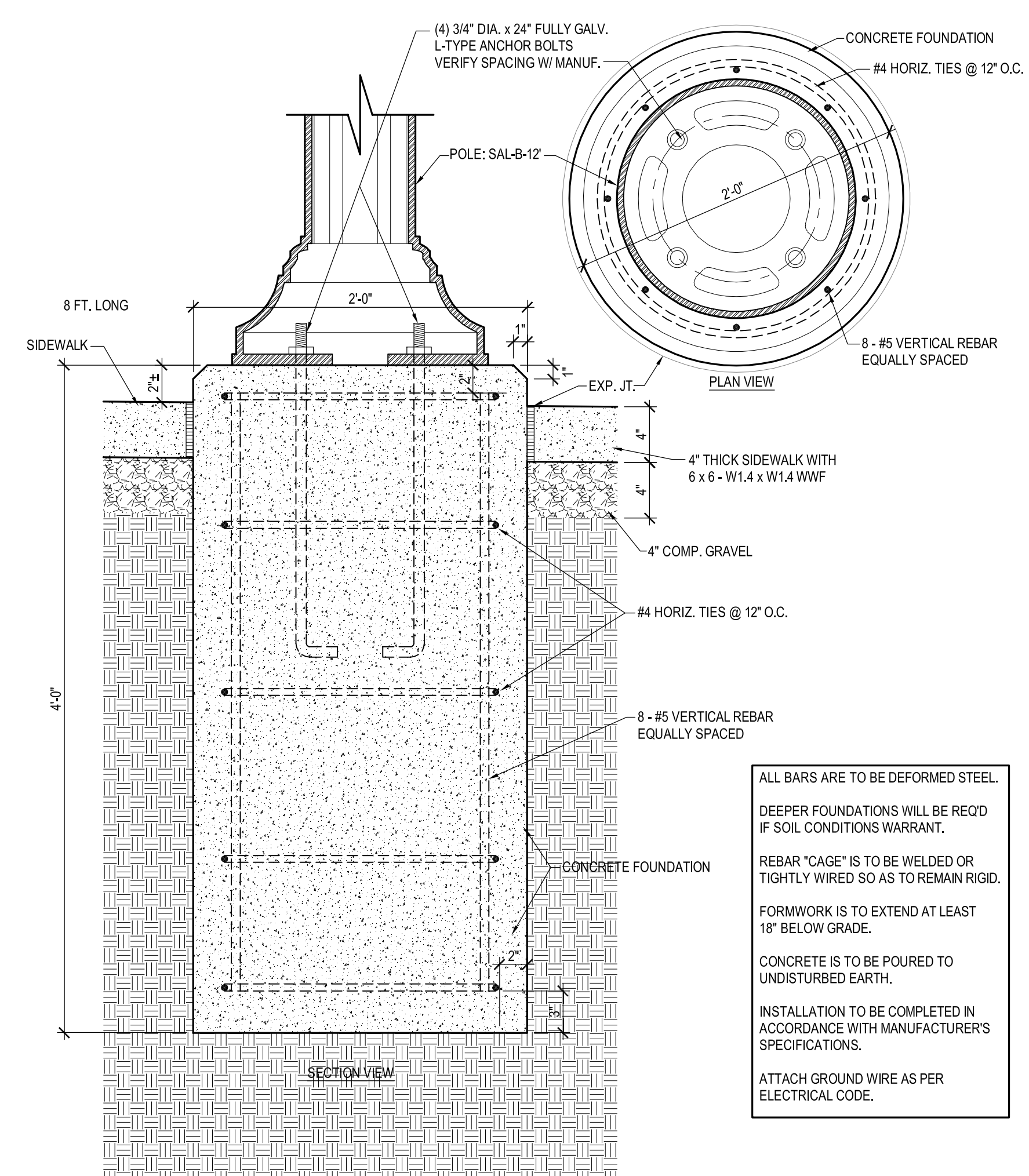

2 LAMP POST BASE
SCALE: 1 1/2" = 1'-0"

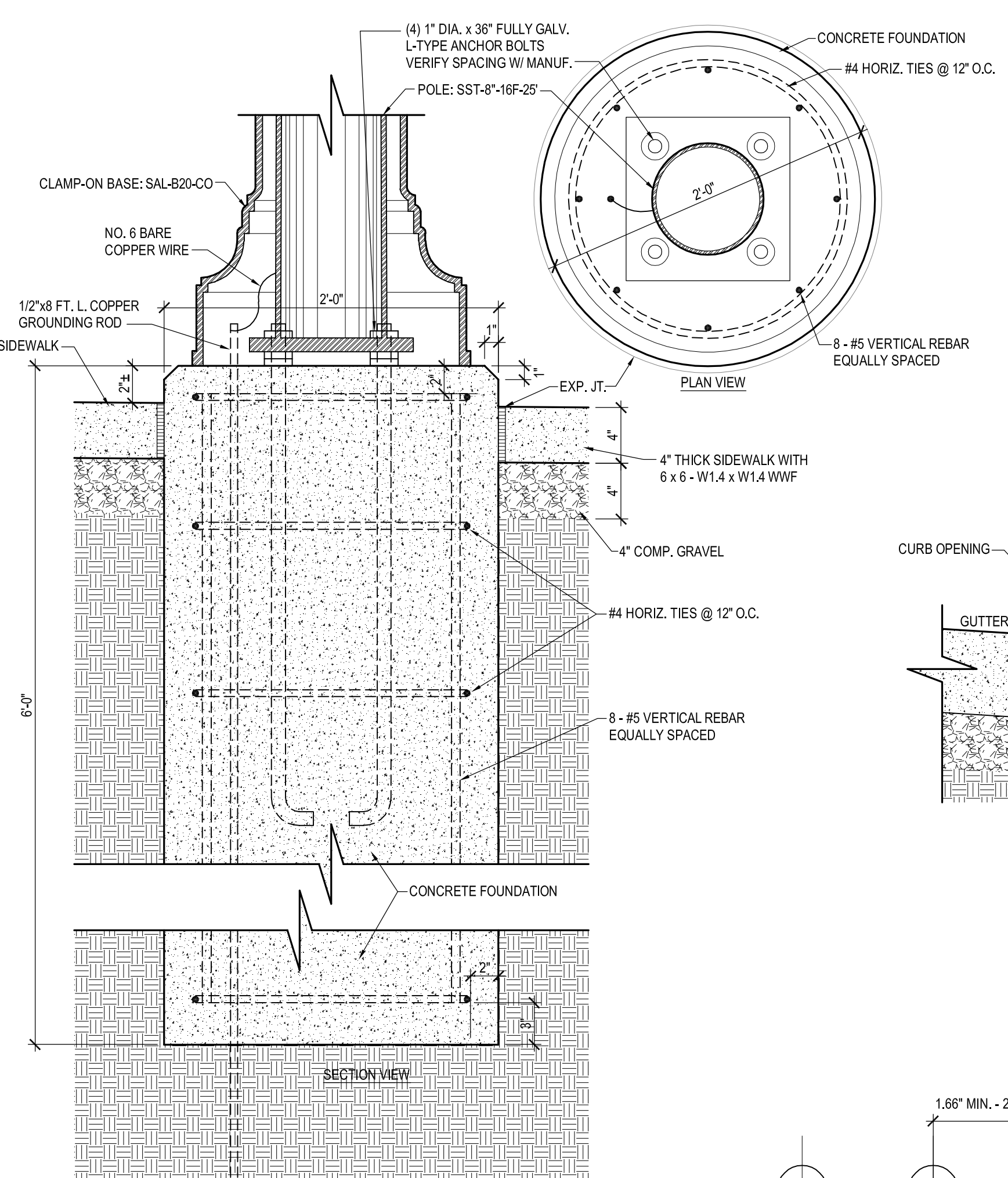

3 STREET LIGHT BASE
SCALE: 1 1/2" = 1'-0"

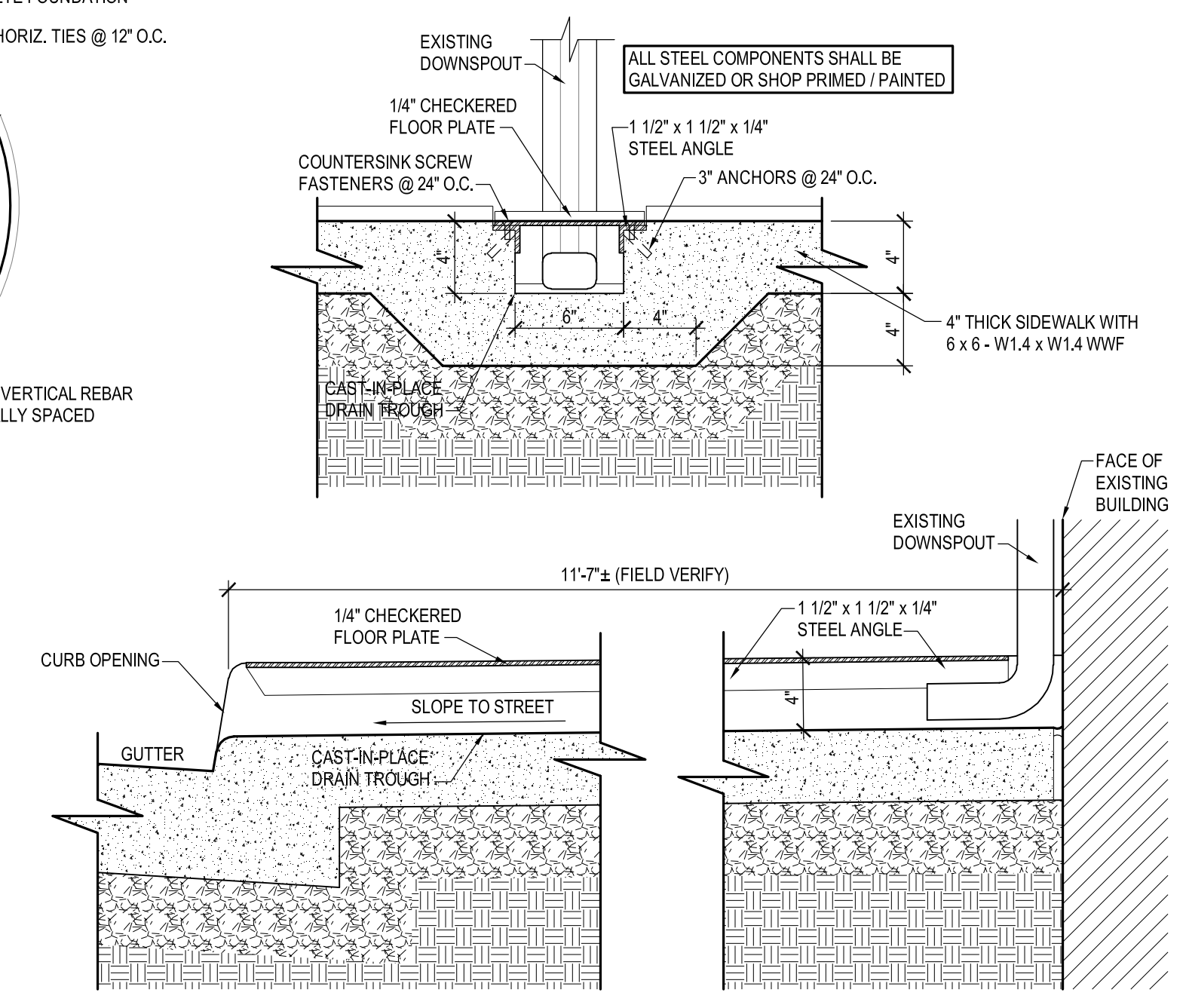

4 CROSS SIDEWALK DRAIN
SCALE: 1 1/2" = 1'-0"

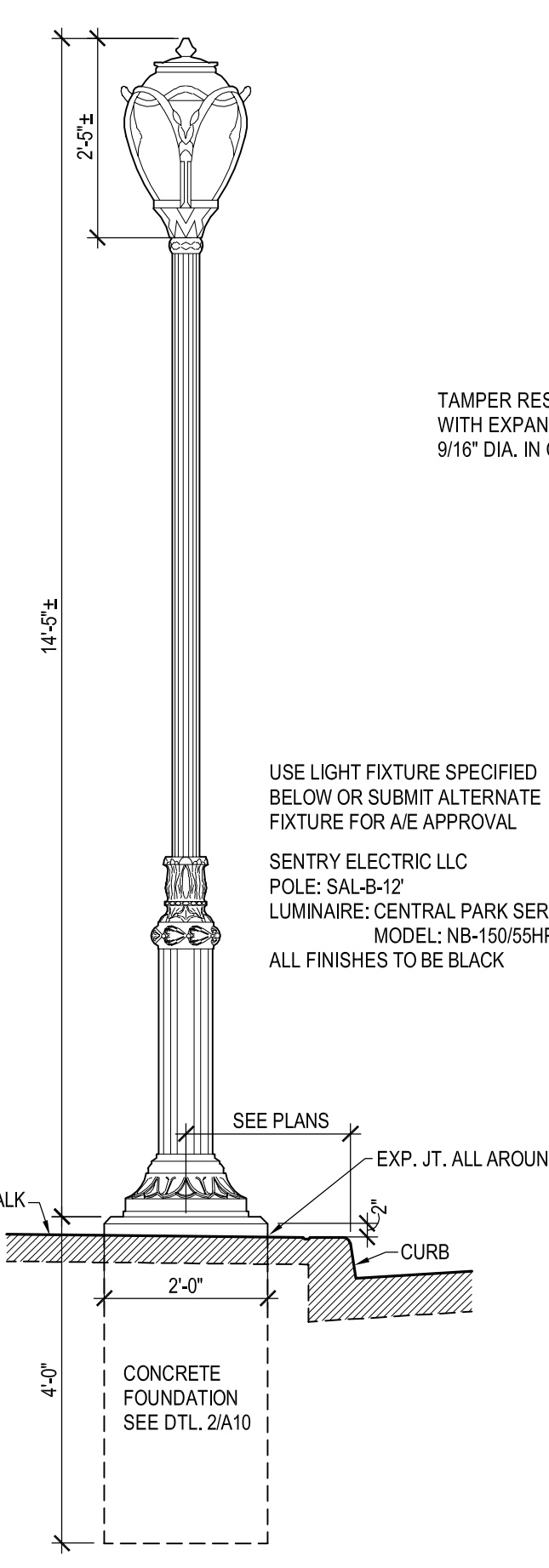

6 LAMP POST
SCALE: 1/2" = 1'-0"

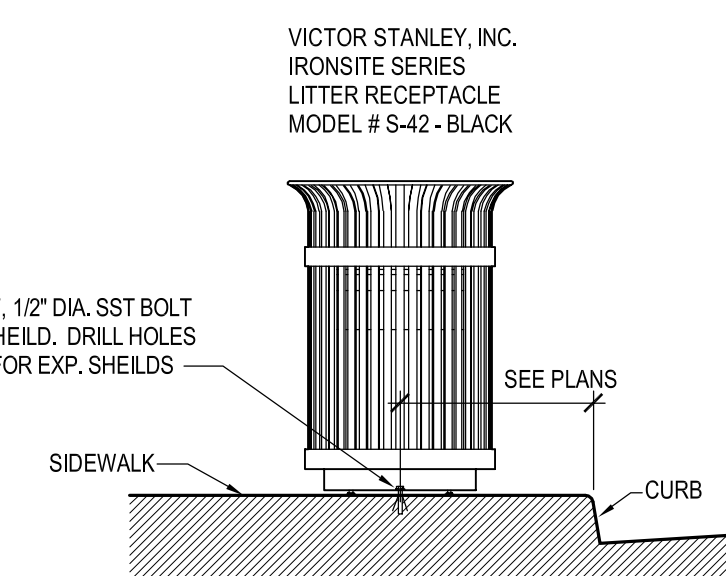

7 TRASH RECEPTACLE
SCALE: 1/2" = 1'-0"

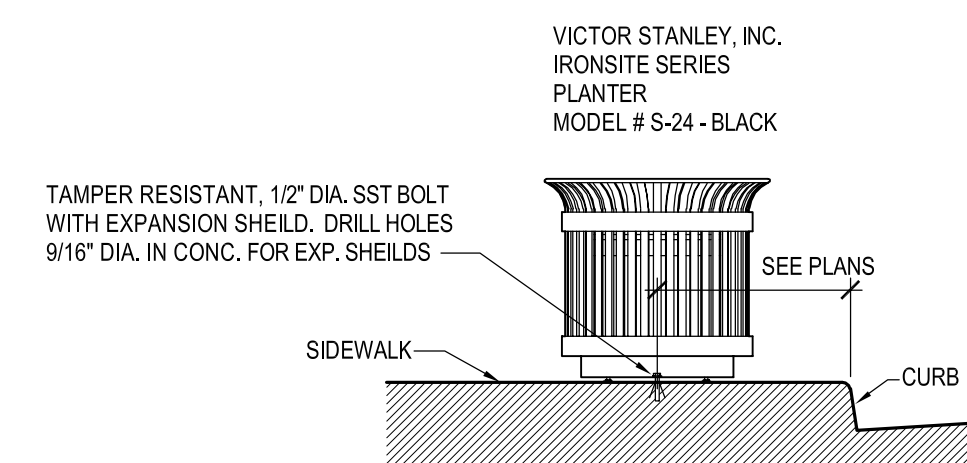

8 PLANTER
SCALE: 1/2" = 1'-0"

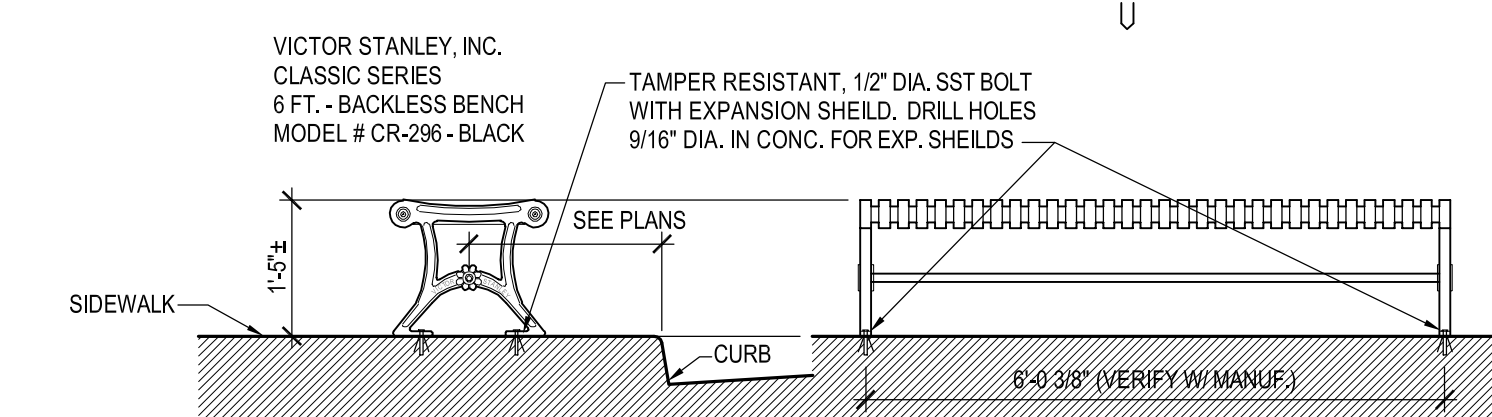

9 BENCH
SCALE: 1/2" = 1'-0"

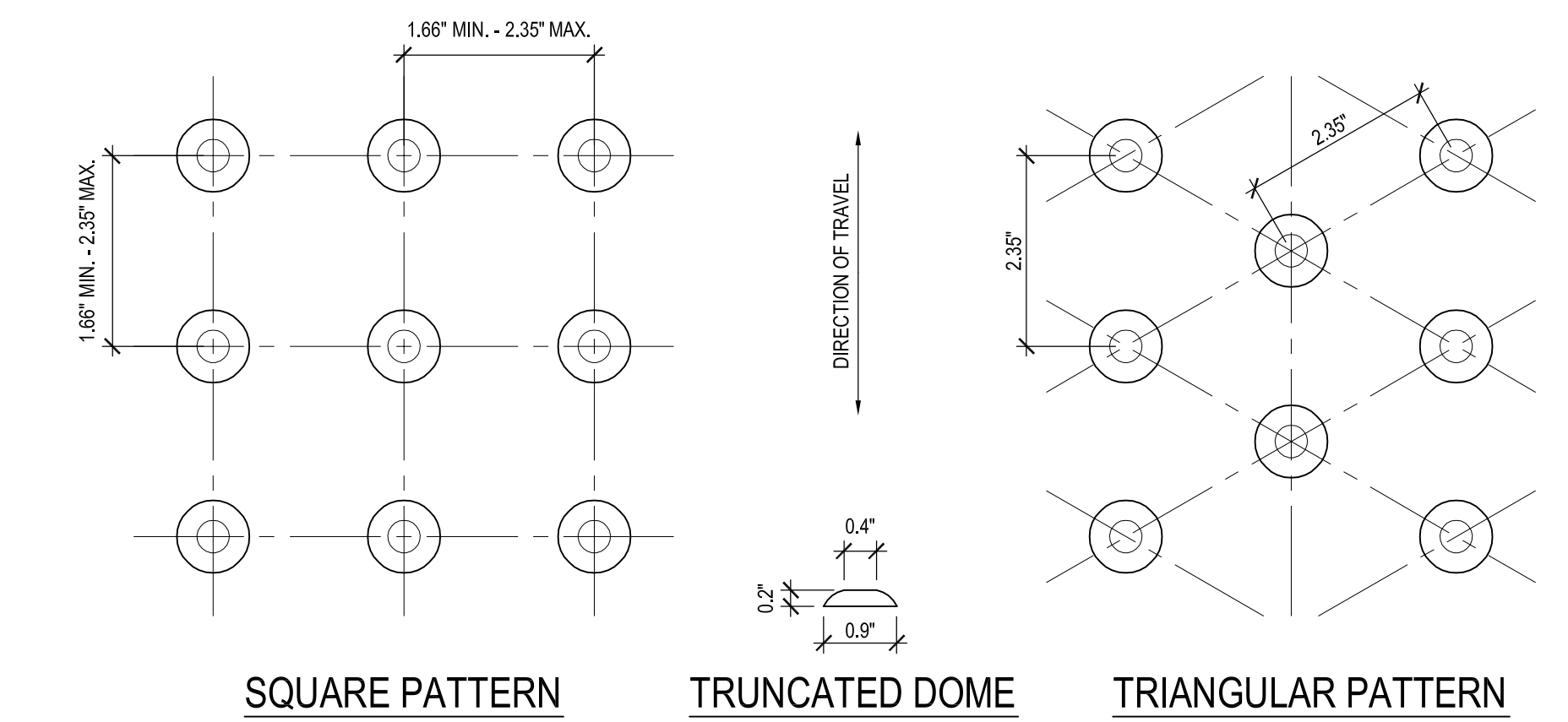

10 DETECTABLE WARNING DETAIL
SCALE: 6" = 1'-0"

CONCRETE NOTES

DECORATIVE CONCRETE (Butterfield Color specifications used - contractor may submit other products of equal or better quality for approval.)

1.1 SUMMARY

A. Section Includes:

- Integrally colored concrete pavement.
- Stamped concrete pavement.

1.2 SUBMITTALS

A. Submit according to Conditions of the Contract and Division 1 Specification Sections.

B. Product Data: For each product indicated.

C. Mix Designs: For each type of integrally-colored concrete mix required.

D. Samples for Initial Selection: Manufacturer's color charts.

1.3 QUALITY ASSURANCE

A. Installer Qualifications: Two year's experience with projects of similar scope and quality.

B. Manufacturer's Qualifications: Three year's experience manufacturing products required.

C. Source Limitations: Obtain products from same source throughout Project.

D. Field Samples: Locate at site and obtain approval before start of final work. Field samples shall be minimum 4 by 4 feet by full thickness.

- Demonstrate range of finishes and workmanship, including curing procedures.
- Approved field samples set quality standards for comparison with remaining work.
- Approved field samples may become part of the completed Work if undisturbed at completion of Project.

1.4 DELIVERY, STORAGE AND HANDLING

A. Deliver materials in original packaging with labels intact.

B. Store in clean, dry and protected location, according to manufacturer's requirements.

1.5 COLOR MATERIALS

A. Integrally Colored Concrete Liquid Colorant: ASTM C 979, admixture for integrally coloring concrete, consisting of non-fading synthetic mineral-oxides coloring pigments suspended in a pH adjusted water-based solution, dispersed at the batch plant, or premeasured in pails for job-site addition.

- Product: Butterfield Color® Uni-Mix® Liquid Colorant.
- Colors: As selected by Architect.

B. Pigmented-Powder Release Agent: Factory-packaged, nonfading finely-ground, streak free, colored powder that facilitates release of stamps and texture rollers from colored concrete and imparts a secondary accent color.

- Product: Butterfield Color® Perma-Cast® Antiquing Release.
- Colors: As selected by Architect.

1.6 IMPRINTING TOOLS

A. Stamp Mats: Semi-rigid polyurethane mats with projected texture and ridged underside capable of imprinting texture and joint patterns to plastic concrete.

- Manufacturer: Butterfield Color®.
- Pattern: BST6100 - Brick Basket Weave

B. Accessory Stamp Tools: Aluminum detailing tools capable of imprinting joints and dressing stamped joints of plastic concrete.

- Product: Butterfield Color® Stamp Tools.

1.7 RELATED MATERIALS

A. Bonding Agent: ASTM C 1059, Type II.

1.8 CURING AND SEALING MATERIALS

A. Clear, Solvent-Borne, Membrane-Forming Curing and Sealing Compound: ASTM C 309, non-yellowing, VOC-compliant, high-gloss, clear liquid.

- Product: Butterfield Color® Clear-Guard™ Cure & Seal.

B. Flatten Paste: Manufacturer's standard product designed to reduce sealer gloss finish to matte finish.

- Product: Butterfield Color® Flatten Paste.

C. Slip-Resistive Additive: Finely graded aggregate or polymer additive designed to add to sealer for slip-resistant surface.

1.9 INTEGRAL CONCRETE MIXES

- Minimum Portland Cement Content: Five sacks of cement per cubic yard.
- Maximum Slump: 4 inches.
- Air Content: 5 percent plus or minus 1 percent.

B. Add integral concrete colorant according to manufacturer's instructions.

C. Maintain mix characteristics for all concrete required to have matching finish.

PART 2 - EXECUTION

2.1 EXAMINATION

- Examine subgrade and sub base for compliance with requirements.
- Do not proceed with decorative cement concrete pavement until unacceptable conditions are corrected.

2.2 CONCRETE PLACEMENT

A. Do not add water once placing has begun. Do not retemper concrete that has started to set.

2.3 STAMPING

A. Stamp concrete surfaces according to manufacturer's instructions.

B. Mat Stamping: While concrete is plastic, accurately align stamp mats in sequence and uniformly press into concrete to produce imprint pattern, texture, and depth of imprint, according to manufacturer's instructions. Remove stamps from concrete immediately.

- Stamp edges and surfaces unable to be imprinted with stamp mat with flexible stamping mats.
- Remove unembedded pigmented powder release agent after interval recommended by manufacturer and according to manufacturer's instructions. Pressure wash surfaces according to manufacturer's instructions without damaging decorative concrete.

2.4 CURING AND SEALING

A. Protect decorative cement concrete pavement from prematurely drying and excessive cold or hot temperatures.

B. Cure decorative cement concrete pavement according to manufacturer's instructions.

C. Curing and Sealing Compound: Apply uniformly in continuous operation by sprayer or short nap roller according to manufacturer's instructions. After initial application is dry and tack free, apply a second coat.

- Do not over apply or apply in a single heavy coat.
- Thoroughly mix flatten paste in curing and sealing compound according to manufacturer's instructions. Stir occasionally to maintain uniform distribution of paste.
- Thoroughly mix slip-resistive additive in sealer according to manufacturer's instructions. Stir occasionally to maintain uniform distribution of additive.
- Verify adequacy of slip resistance before opening up surfaces to traffic.
- Do not cover concrete with plastic sheeting.

2.5 REPAIRS AND PROTECTION

A. Repair damaged decorative cement concrete pavement according to manufacturer's instructions.

B. Clean spillage and soiling from adjacent construction according to manufacturer's instructions.

C. Protect decorative cement concrete pavement from damage or deterioration until date of Substantial Completion.

ALL CONCRETE WORK SHALL COMPLY WITH THE ILLINOIS DEPARTMENT OF TRANSPORTATION STANDARD SPECIFICATIONS FOR ROAD AND BRIDGE CONSTRUCTION ADOPTED JANUARY 1, 2007 Online Reference at: (<http://dot.state.il.us/ddsenv/stdspcs07.html>)

CLASS OF CONC.	USE	CEMENT FACTOR CWT / CU YD		WATER / CEMENT RATIO LB / LB	SLUMP IN. (3)	MIX DESIGN COMPRESSIVE STRENGTH (FLEXURAL STRENGTH) PSI, MINIMUM - 14 DAYS	AIR CONTENT %	COURSE AGGREGATE GRADATIONS
		MIN.	MAX.					
SI	SIDEWALK CURB / GUTTER LIGHT FOUNDATIONS	5.65 (1)	7.05	0.32-0.46	2-4	3,500 (650)	5.0 - 8.0	CA7, CA1 or CA14

(1) CENTRAL MIXED
(2) TRUCK MIXED OR SHRINK MIXED
(3) THE MAXIMUM SLUMP MAY BE INCREASED TO 7 IN. WHEN A HIGH RANGE WATER-REDUCING ADMIXTURE IS USED.

THE A.C.I. BUILDING CODE REQUIREMENTS FOR REINFORCED CONCRETE (ACI 318-05) SHALL DETERMINE ALL REINFORCED CONCRETE DETAIL WORK NOT SHOWN OR SPECIFIED.

BAR SUPPORTS AND ACCESSORIES SHALL BE IN ACCORDANCE WITH THE MANUAL OF STANDARD PRACTICES FOR DETAILING REINFORCED CONCRETE STRUCTURES (ACI 315-2).

ALL CONCRETE SHALL HAVE A MINIMUM 28-DAY STRENGTH OF 3,500 PSI, EXCEPT FOR 'LEAN' CONCRETE. 'LEAN' CONCRETE SHALL HAVE A MINIMUM 28-DAY STRENGTH OF 700 PSI.

REINFORCEMENT SHALL BE ASTM A 615, GRADE 60.

THE CONTRACTOR SHALL MAKE ALLOWANCE FOR DEAD LOAD DEFLECTION, SETTLEMENT OF FORMS, AND SHRINKAGE OF CONCRETE WHEN CONSTRUCTING OF CONCRETE WORK.

THE CONTRACTOR ALONE IS RESPONSIBLE FOR THE ADEQUACY OF ALL FORMS, SHORING, BRACING, ETC. USED IN CONSTRUCTION OF CONCRETE WORK.

WELDED WIRE FABRIC SHALL CONFORM TO ASTM A 185.

ALL EXCAVATIONS SHALL BE FREE OF DEBRIS, STANDING WATER AND LOOSE SOIL PRIOR TO PLACEMENT OF CONCRETE.

CONCRETE SHALL NOT BE PLACED ON FROZEN SOIL.

EXCAVATIONS THAT BECOME MUDDY AND SOFT DUE TO CONSTRUCTION ACTIVITY SHALL HAVE A LEAN CONCRETE MUD SLAB OR GRAVEL PLACED IN THE EXCAVATION TO PROVIDE ACCEPTABLE BEARING.

ANCHOR BOLTS SHALL CONFORM TO ASTM F1554, GRADE 36 KSI.

ALL DIMENSIONS AFFECTED BY NEW CONSTRUCTION TO BE VERIFIED BY CONTRACTOR BEFORE COMMENCING CONSTRUCTION.

Illinois law requires anyone digging, regardless of the depth of the project, to call JULIE at 1-800-892-0123. This notice must be at least 48 hours/two working days prior to the start of excavation and the project must begin within 14 calendar days from the call.

FINAL REVIEW DRAWINGS - NOT FOR CONSTRUCTION



NOTE: CONTRACTOR SHALL OBTAIN AND VERIFY ALL DIMENSIONS AND CONDITIONS AT JOB SITE AND BE FULLY RESPONSIBLE FOR SAME.

DETAILS		PROJ. NO.: 0809
City of Litchfield, Illinois - Downtown Streetscape - Phase 1		DATE: 01-21-09
City of Litchfield, 120 E Ryder St, Litchfield, Illinois 62056		SHEET: A10
		SHEET 10 OF 11